

K-MUFFEN RUND

Sockets, round

HANSA FLEX

Lastnosti

delovni tlak	Max. 20 bar
notranji navoj	Parallel to DIN EN ISO 228-1
Material:	Stainless steel 1.4408

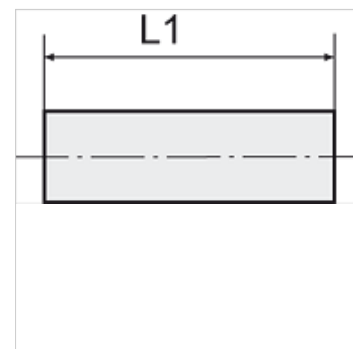

Navodilo

The dimensions of the standard screw fittings may change slightly during the life of the catalogue as a result of optimisation processes.
Drugi podatki na zahtevo.

Artikel

Opis	Navoj	L1 (mm)
K- 07 40 14 88	G 1/8	25,0
K- 07 40 14 89	G 1/4	25,4
K- 07 40 14 90	G 3/8	30,0
K- 07 40 14 91	G 1/2	35,0
K- 07 40 14 92	G 3/4	38,6
K- 07 40 14 93	G 1	43,9
K- 07 40 14 94	G 1 1/4	50,1
K- 07 40 14 95	G 1 1/2	53,6
K- 07 40 14 96	G 2	63,0