

K-VSTOK 4

Plugs, square

HANSA FLEX

Lastnosti

delovni tlak	Max. 20 bar
zunANJI navoj	Parallel to DIN EN ISO 228-1
Material:	Stainless steel 1.4408

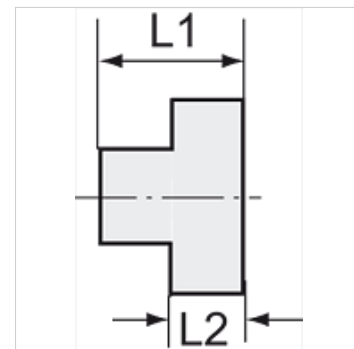
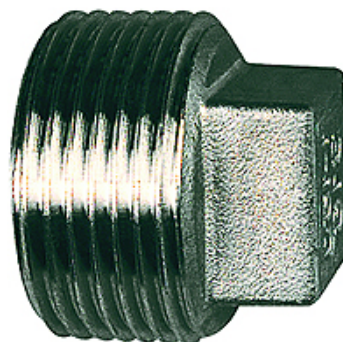

Navodilo

The dimensions of the standard screw fittings may change slightly during the life of the catalogue as a result of optimisation processes.
Drugi podatki na zahtevo.

Artikel

Opis	Navoj	L1 (mm)	L2 (mm)	zev ključa
K- 07 40 39 73	G 1/8	13,9	7,0	6 mm
K- 07 40 39 74	G 1/4	19,4	11,2	9 mm
K- 07 40 39 75	G 3/8	17,8	10,0	10 mm
K- 07 40 39 76	G 1/2	25,0	15,8	14 mm
K- 07 40 39 77	G 3/4	28,0	17,0	17 mm
K- 07 40 39 78	G 1	31,0	19,0	19 mm
K- 07 40 39 79	G 1 1/4	35,0	21,9	23 mm
K- 07 40 39 80	G 1 1/2	36,0	21,9	26 mm
K- 07 40 39 81	G 2	40,4	25,4	32 mm