

K-VERBINDER

Unions

HANSA FLEX

Lastnosti

maks. delovni tlak	18 bar
uporabne cevi	PA, PE, PU
Material:	ponikljana medenina

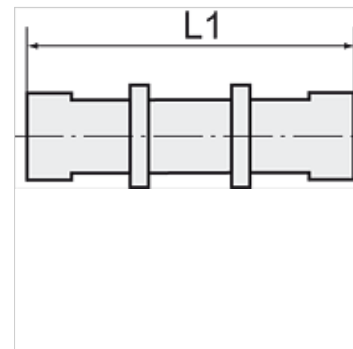
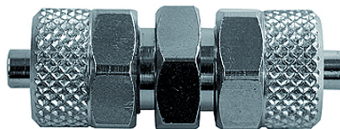

Navodilo

Drugi podatki na zahtevo.

Artikel

Opis	za cev	L1 (mm)	zev ključa
K- 07 40 33 69	5 mm / 3 mm	28,5	8 mm
K- 07 40 33 70	6 mm / 4 mm	34,5	12 mm
K- 07 40 33 71	8 mm / 6 mm	35,0	14 mm
K- 07 40 33 67	10 mm / 8 mm	38,0	14 mm
K- 07 40 33 68	12 mm / 10 mm	41,0	17 mm