

K-GAM IG 4

Female connectors, female thread

HANSA FLEX

Lastnosti

| | |
|--------------------|---------------------|
| maks. delovni tlak | 18 bar |
| uporabne cevi | PA, PE, PU |
| Material: | ponikljana medenina |

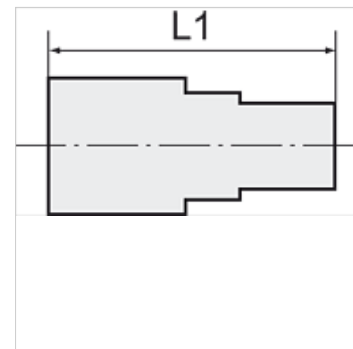
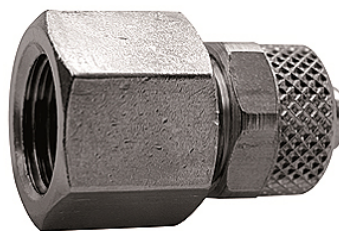

Navodilo

Drugi podatki na zahtevo.

Artikel

| Opis | Navoj | za cev | L1 (mm) | zev ključa |
|----------------|-------|--------------|------------|------------|
| K- 07 40 33 77 | G 1/8 | 6 mm / 4 mm | 25,0 | 14 mm |
| K- 07 40 33 78 | G 1/8 | 8 mm / 6 mm | 25,0 | 14 mm |
| K- 07 40 33 75 | G 1/4 | 6 mm / 4 mm | 29,0 | 17 mm |
| K- 07 40 33 76 | G 1/4 | 8 mm / 6 mm | 29,0 | 17 mm |
| K- 07 40 33 74 | G 1/4 | 10 mm / 8 mm | 30,5 | 17 mm |
| K- 07 40 33 73 | G 1/2 | 8 mm / 6 mm | 33,0 | 24 mm |
| K- 07 40 33 72 | G 1/2 | 10 mm / 8 mm | 34,5 | 24 mm |
| K- 07 40 33 80 | G 3/8 | 6 mm / 4 mm | 29,5 | 20 mm |
| K- 07 40 33 81 | G 3/8 | 8 mm / 6 mm | 29,5 | 20 mm |
| K- 07 40 33 79 | G 3/8 | 10 mm / 8 mm | 31,0 | 20 mm |