

K-SCHLAUCHTUELLEN ES

Hose fittings

HANSA FLEX

Lastnosti

delovni tlak Max. 20 bar

Material: legirano jeklo 1.4571

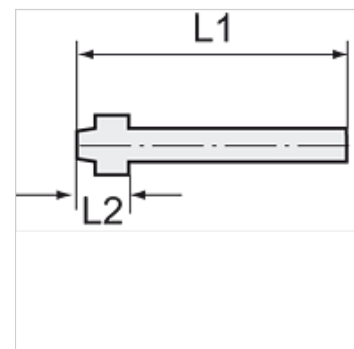
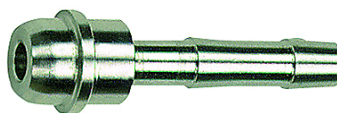

Navodilo

The dimensions of the standard screw fittings may change slightly during the life of the catalogue as a result of optimisation processes.
Drugi podatki na zahtevo.

Dodatne informacije

Further types and dimensions on request.

Artikel

| Opis | za cev | za krovno matico | L1 (mm) | L2 (mm) |
|----------------|----------|------------------|------------|------------|
| K- 07 40 16 51 | LW 6 mm | G 1/8 | 33,5 | 6,0 |
| K- 07 40 16 44 | LW 4 mm | G 1/4 | 47,0 | 13,5 |
| K- 07 40 16 45 | LW 6 mm | G 1/4 | 47,0 | 13,5 |
| K- 07 40 16 46 | LW 9 mm | G 1/4 | 47,0 | 14,0 |
| K- 07 40 16 47 | LW 6 mm | G 3/8 | 48,5 | 15,0 |
| K- 07 40 16 48 | LW 9 mm | G 3/8 | 48,5 | 15,0 |
| K- 07 40 16 49 | LW 9 mm | G 1/2 | 48,5 | 15,0 |
| K- 07 40 16 50 | LW 13 mm | G 1/2 | 48,5 | 15,0 |