

# K-W90 DREH AG OR FKM

Male elbows, swivel type, parallel male thread with FPM O-ring

**HANSA FLEX**

## Lastnosti

delovni tlak Max. 18 bar

tesnilni material Buna-N

Material: ponikljana medenina

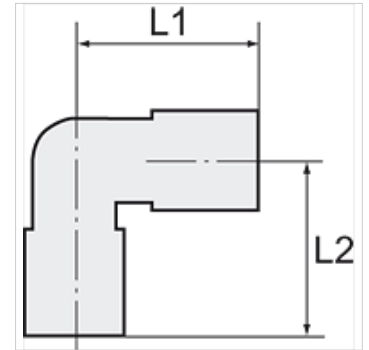

## Navodilo

Drugi podatki na zahtevo.

## Artikel

| Opis           | Navoj | za cev       | L1<br>(mm) | L2<br>(mm) | zev ključa |
|----------------|-------|--------------|------------|------------|------------|
| K- 07 40 31 49 | G 1/8 | 6 mm / 4 mm  | 20,5       | 21,0       | 10 mm      |
| K- 07 40 31 51 | G 1/8 | 8 mm / 6 mm  | 21,0       | 21,0       | 10 mm      |
| K- 07 40 31 45 | G 1/4 | 6 mm / 4 mm  | 21,5       | 22,5       | 10 mm      |
| K- 07 40 31 47 | G 1/4 | 8 mm / 6 mm  | 22,0       | 24,0       | 12 mm      |
| K- 07 40 31 43 | G 1/4 | 10 mm / 8 mm | 24,0       | 24,0       | 12 mm      |