

K-TUE 7,2 7,8 MS

Stems for couplings DN 7.2 - DN 7.8, both sides sealing, brass

HANSA FLEX

Lastnosti

Obratovalni tlak	0 - 35 bar, maximum static working pressure (non-pulsating)
pretok zraka	700 l/min (at 6 bar and $\Delta p = 0.5$ bar)
temperatura medija	-20 °C to +100 °C
Material:	med

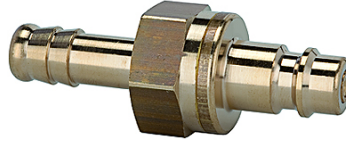

Navodilo

Drugi podatki na zahtevo.

Artikel

Opis	definicija
K- 07 35 02 17	Stem, I.D. 6
K- 07 35 12 68	Stem, I.D. 8
K- 07 35 02 18	Stem, I.D. 9
K- 07 35 12 69	Stem, I.D. 10
K- 07 35 02 19	Stem, I.D. 13