

K-SCHOTT-STECKVERB ABSP

Female bulkhead stop unions (pressure max. 10 bar)

Lastnosti

delovni tlak	Max. 10 bar, vacuum
Območje uporabe	Air, vacuum
priporočene cevi	PU or PA (nylon)
Sredstva	stisnjen zrak
Standard	M thread acc. to DIN 13-1, with O-Ring
območje temperatur:	0 °C to +60 °C
Material:	Plastic, Nickel plated brass
potisni obroč	Plastic

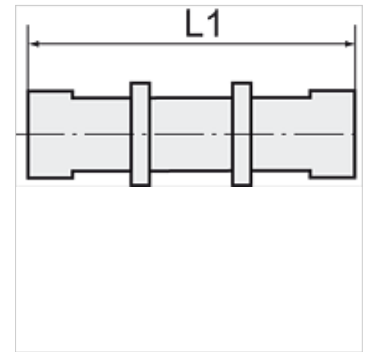
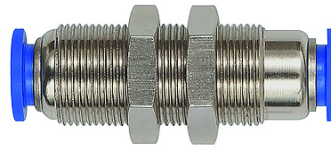

Navodilo

Drugi podatki na zahtevo.

Opis

The air supply is completely shut off as soon as the hose is disconnected from the union. The flow rate is only guaranteed if the hose is securely inserted.

Artikel

Opis	Navoj	za zunanji Ø mm cevi	L1 (mm)	zev ključa
K- 07 40 43 74	M 12 x 1,5	4 mm	41,0	14 mm
K- 07 40 43 75	M 14 x 1,5	6 mm	44,5	17 mm
K- 07 40 43 76	M 16 x 1,5	8 mm	50,3	19 mm
K- 07 40 43 77	M 20 x 1,5	10 mm	58,5	24 mm
K- 07 40 43 78	M 24 x 1,5	12 mm	62,2	27 mm