

K-L-STECKVER DREH MINI

Male elbows, swivel type, mini

HANSA FLEX

Lastnosti	
delovni tlak	Max. 10 bar, vacuum
Območje uporabe	Air, vacuum
priporočene cevi	PU or PA (nylon)
Sredstva	stisnjen zrak
Standard	M thread acc. to DIN 13-1, with O-Ring G thread acc. to DIN EN ISO 228-1, with O-Ring R thread acc. to ISO 7-1, thread coating
območje temperatur:	0 °C to +60 °C
tesnilna ploskev	O-ring (NBR)
Material:	Plastic, Nickel plated brass
potisni obroč	Plastic

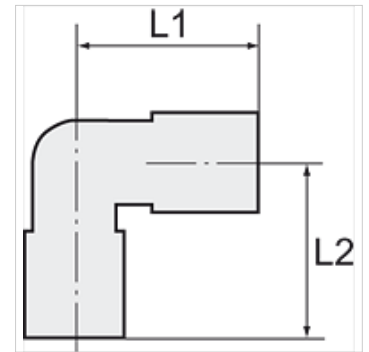
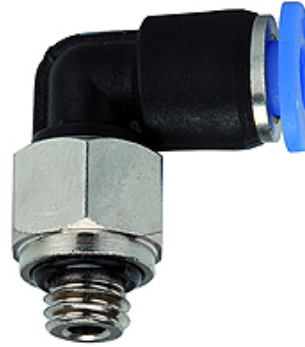

Navodilo

Drugi podatki na zahtevo.

Opis

Push-in fittings series manufactured in plastic and nickel-plated brass, space-saving miniature design.

Artikel

Opis	Navoj	za zunanji Ø mm cevi	L1 (mm)	L2 (mm)	zev ključa
K- 07 40 23 43	M 3	3 mm	12,0	16,0	8 mm
K- 07 40 23 44	M 3	4 mm	14,0	17,2	8 mm
K- 07 40 23 45	M 5	3 mm	12,0	16,0	8 mm
K- 07 40 23 46	M 5	4 mm	14,0	17,2	8 mm
K- 07 40 23 47	M 5	6 mm	16,0	17,2	8 mm
K- 07 40 23 48	M 6	3 mm	12,0	16,5	10 mm
K- 07 40 23 49	M 6	4 mm	14,0	17,6	10 mm
K- 07 40 23 50	M 6	6 mm	16,0	17,6	10 mm
K- 07 40 23 51	G 1/8	4 mm	14,0	16,5	13 mm
K- 07 40 23 52	G 1/8	6 mm	16,0	16,5	13 mm
K- 07 40 23 65	R 1/8	4 mm	14,0	18,0	10 mm
K- 07 40 23 66	R 1/8	6 mm	16,0	18,0	10 mm
K- 07 40 50 05	M 7	4 mm	14,0	15,7	10 mm
K- 07 40 50 06	M 7	6 mm	16,3	17,2	10 mm