

K-L-STECKVER DREH AG-K VA

Male elbows, swivel type, conical male thread

HANSA FLEX

Lastnosti

impulzni delovni tlak	Max. 10 bar
tlak	Max. 15 bar (depending on pipe quality)
primeren material cevi	PVDF, PTFE, stainless steel, PA, PU
Standard	R thread acc. to ISO 7-1
temperatura okolice	-20 °C to max. +150 °C (depending on pipe quality and diameter)
Material:	legirano jeklo 1.4404
tesnilni material	FKM

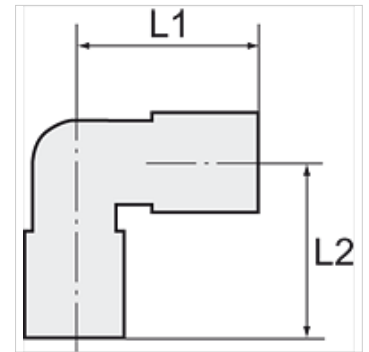

Navodilo

Drugi podatki na zahtevo.

Opis

For use with aggressive media and in areas with corrosive outside influences, in the food processing industry and in hygienic and sanitary applications.

Artikel

Opis	Navoj	za zunanji Ø mm cevi	L1 (mm)	L2 (mm)	zev ključa
K- 07 40 24 44	R 1/8	4 mm	17,0	17,5	10 mm
K- 07 40 24 45	R 1/8	6 mm	21,5	20,0	13 mm
K- 07 40 24 46	R 1/8	8 mm	22,0	20,0	13 mm
K- 07 40 24 42	R 1/4	6 mm	21,5	24,0	14 mm
K- 07 40 24 43	R 1/4	8 mm	22,0	24,0	14 mm
K- 07 40 24 41	R 1/4	10 mm	25,5	26,5	16 mm
K- 07 40 24 47	R 3/8	10 mm	25,5	27,0	17 mm
K- 07 40 24 48	R 3/8	12 mm	28,0	30,5	22 mm
K- 07 40 24 40	R 1/2	12 mm	28,0	33,5	22 mm