

# K-GEWINDE-STECKNIPPEL AGR OR

Push-in plug, parallel male thread with O-ring

**HANSA FLEX**

## Lastnosti

|                     |                     |
|---------------------|---------------------|
| delovni tlak        | Max. 16 bar         |
| delovna temperatura | -20 °C to +80 °C    |
| Material:           | ponikljana medenina |
| potisni obroč       | Hostaform           |
| tesnilni obroč      | NBR                 |
| vpenjalni obroč     | Stainless steel     |

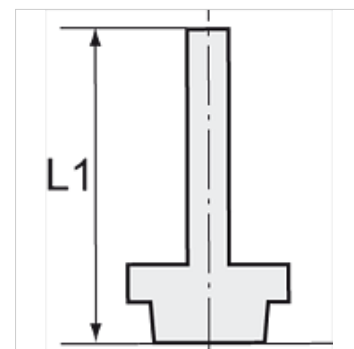

## Navodilo

Drugi podatki na zahtevo.

## Opis

The advanced version of our highly successful push-in fittings series manufactured in nickel-plated brass. Advantages of this new, optimised series: Much easier connection and disconnection of the hose, even with repeated mounting, can also be used for non-calibrated hoses, suitable for vacuum operation.

## Artikel

| Opis           | Navoj | za zunanji Ø mm cevi | L1<br>(mm) | zev ključa |
|----------------|-------|----------------------|------------|------------|
| K- 07 40 47 32 | M 5   | 3 mm                 | 17,1       | 5 mm       |
| K- 07 40 47 33 | M 5   | 4 mm                 | 25,2       | 8 mm       |
| K- 07 40 47 34 | M 5   | 5 mm                 | 25,2       | 8 mm       |
| K- 07 40 47 35 | M 5   | 6 mm                 | 25,7       | 9 mm       |
| K- 07 40 47 45 | G 1/8 | 4 mm                 | 28,9       | 13 mm      |
| K- 07 40 47 46 | G 1/8 | 5 mm                 | 28,9       | 13 mm      |
| K- 07 40 47 47 | G 1/8 | 6 mm                 | 29,4       | 13 mm      |
| K- 07 40 47 48 | G 1/8 | 8 mm                 | 30,6       | 13 mm      |
| K- 07 40 47 41 | G 1/4 | 4 mm                 | 32,4       | 14 mm      |
| K- 07 40 47 42 | G 1/4 | 5 mm                 | 32,4       | 14 mm      |
| K- 07 40 47 43 | G 1/4 | 6 mm                 | 32,9       | 14 mm      |
| K- 07 40 47 44 | G 1/4 | 8 mm                 | 34,0       | 14 mm      |
| K- 07 40 47 39 | G 1/4 | 10 mm                | 38,2       | 14 mm      |
| K- 07 40 47 40 | G 1/4 | 12 mm                | 40,7       | 14 mm      |
| K- 07 40 47 52 | G 3/8 | 8 mm                 | 35,4       | 17 mm      |
| K- 07 40 47 49 | G 3/8 | 10 mm                | 38,7       | 17 mm      |
| K- 07 40 47 50 | G 3/8 | 12 mm                | 42,2       | 17 mm      |
| K- 07 40 47 51 | G 3/8 | 14 mm                | 46,2       | 17 mm      |
| K- 07 40 47 36 | G 1/2 | 10 mm                | 41,0       | 19 mm      |
| K- 07 40 47 37 | G 1/2 | 12 mm                | 44,2       | 22 mm      |
| K- 07 40 47 38 | G 1/2 | 14 mm                | 48,2       | 22 mm      |