

# K-EINPRESSPATRONE

Press-in sleeves - can only be pressed into plastic

**HANSA FLEX**

## Lastnosti

<b>delovni tlak</b>	Max. 15 bar, coarse vacuum
<b>Območje uporabe</b>	Air, vacuum
<b>priporočene cevi</b>	PU or PA (nylon)
<b>Sredstva</b>	Compressed air and all gases or liquids that are compatible with the materials
<b>območje temperatur:</b>	-20 °C to +80 °C
<b>tesnilna ploskev</b>	Parallel version: O-ring in housing, Conical version: thread coating
<b>Material:</b>	Plastic, Nickel plated brass
<b>potisni obroč</b>	Plastic

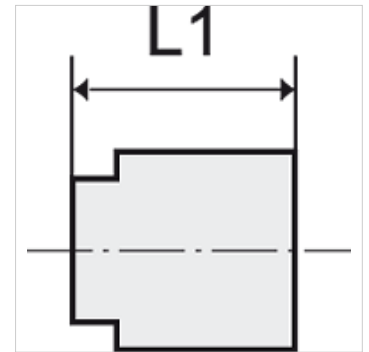
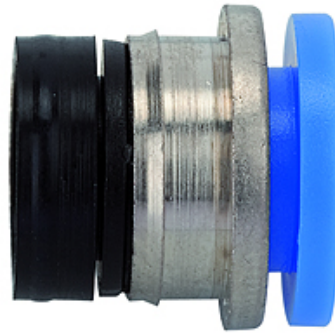

## Navodilo

Only in plastic press-fitted

Drugi podatki na zahtevo.

## Opis

Push-in fittings series manufactured in plastic and nickel-plated brass. All parts are suitable for use with hoses, tubes or pipes made of plastic and copper.

## Artikel

Opis	za zunanji Ø mm cevi	L1 (mm)
K- 07 40 09 95	4 mm	11,3
K- 07 40 09 96	6 mm	11,9
K- 07 40 09 97	8 mm	13,7
K- 07 40 09 98	10 mm	15,2
K- 07 40 09 99	12 mm	17,6