

K-ABSPV STECK

Shut-off valves with plug connection

Lastnosti

| | |
|----------------------------|--|
| delovni tlak | Max. 15 bar, coarse vacuum |
| Območje uporabe | Air, vacuum |
| priporočene cevi | PU or PA (nylon) |
| Sredstva | Compressed air and all gases or liquids that are compatible with the materials |
| območje temperatur: | -20 °C to +80 °C |
| tesnilna ploskev | Parallel version: O-ring in housing, Conical version: thread coating |
| Material: | Plastic, Nickel plated brass |
| potisni obroč | Plastic |

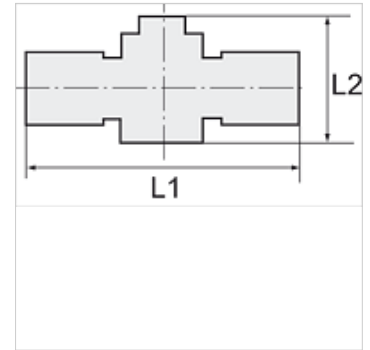

Navodilo

Drugi podatki na zahtevo.

Opis

Push-in fittings series manufactured in plastic and nickel-plated brass. All parts are suitable for use with hoses, tubes or pipes made of plastic and copper.

Artikel

| Opis | za zunanji Ø mm cevi | L1 (mm) | L2 (mm) |
|----------------|----------------------|------------|------------|
| K- 07 40 07 73 | 6 mm | 50,8 | 42,2 |
| K- 07 40 07 74 | 8 mm | 51,8 | 42,3 |
| K- 07 40 07 75 | 10 mm | 63,3 | 46,7 |
| K- 07 40 07 76 | 12 mm | 64,1 | 46,8 |