

Osobine

| | |
|----------------------|---|
| Priključak 1 - 3 | metrički spoljni cilindrični navoj |
| Oblik zaptivke 1 - 3 | 24° unutrašnji konus |
| Konstrukcija | Navojni spoj |
| Konstrukcija | T oblik |
| Norma | DIN 2353 ISO 8434-1 |
| Obim isporuke | Nastavak (bez preklopne navrtke i reznog prstena) |
| Materijal | čelik |
| Površinska zaštita | galvanska prevlaka |

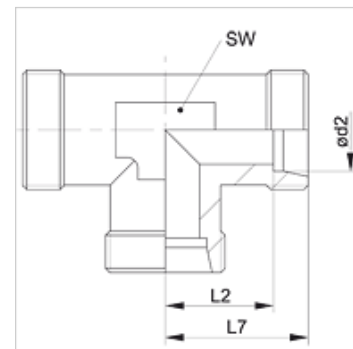

Napomena

Molimo Vas da napomene za montažu, ugradnju, opterećenje pod pritiskom i dozvoljene radne temperature nađete u tehničkim informacijama o navojnim spojevima za cevi.

Artikal

| Naziv | Serija | Radni pritisak bar | Ø d2 (mm) | G1 - G3 | L2 (mm) | L7 (mm) | SW (mm) |
|-------------|--------|--------------------|-----------|------------|---------|---------|---------|
| XT 04 LL | LL | PN 100 | 4 | M 8 x 1 | 11,0 | 15 | 9 |
| XT 05 LL | LL | PN 100 | 5 | M 10 x 1 | 9,5 | 15 | 9 |
| XT 06 LL | LL | PN 100 | 6 | M 10 x 1 | 9,5 | 15 | 9 |
| XT 08 LL | LL | PN 100 | 8 | M 12 x 1 | 11,5 | 17 | 12 |
| XT 10 LL | LL | PN 100 | 10 | M 14 x 1 | 12,5 | 18 | 12 |
| XT 12 LL | LL | PN 100 | 12 | M 16 x 1 | 15,0 | 21 | 14 |
| XT NW 04 HL | L | PN 315 | 6 | M 12 x 1,5 | 12,0 | 19 | 12 |
| XT NW 06 HL | L | PN 315 | 8 | M 14 x 1,5 | 14,0 | 21 | 12 |
| XT NW 08 HL | L | PN 315 | 10 | M 16 x 1,5 | 15,0 | 22 | 14 |
| XT NW 10 HL | L | PN 315 | 12 | M 18 x 1,5 | 17,0 | 24 | 17 |
| XT NW 13 HL | L | PN 315 | 15 | M 22 x 1,5 | 21,0 | 28 | 19 |
| XT NW 16 HL | L | PN 315 | 18 | M 26 x 1,5 | 23,5 | 31 | 24 |
| XT NW 20 HL | L | PN 160 | 22 | M 30 x 2 | 27,5 | 35 | 27 |
| XT NW 25 HL | L | PN 160 | 28 | M 36 x 2 | 30,5 | 38 | 36 |
| XT NW 32 HL | L | PN 160 | 35 | M 45 x 2 | 34,5 | 45 | 41 |
| XT NW 40 HL | L | PN 160 | 42 | M 52 x 2 | 40,0 | 51 | 50 |
| XT NW 03 HS | S | PN 630 | 6 | M 14 x 1,5 | 16,0 | 23 | 12 |
| XT NW 04 HS | S | PN 630 | 8 | M 16 x 1,5 | 17,0 | 24 | 14 |
| XT NW 06 HS | S | PN 630 | 10 | M 18 x 1,5 | 17,5 | 25 | 17 |
| XT NW 08 HS | S | PN 630 | 12 | M 20 x 1,5 | 21,5 | 29 | 17 |
| XT NW 10 HS | S | PN 630 | 14 | M 22 x 1,5 | 22,0 | 30 | 19 |
| XT NW 13 HS | S | PN 400 | 16 | M 24 x 1,5 | 24,5 | 33 | 24 |
| XT NW 16 HS | S | PN 400 | 20 | M 30 x 2 | 26,5 | 37 | 27 |
| XT NW 20 HS | S | PN 400 | 25 | M 36 x 2 | 30,0 | 42 | 36 |
| XT NW 25 HS | S | PN 400 | 30 | M 42 x 2 | 35,5 | 49 | 41 |
| XT NW 32 HS | S | PN 315 | 38 | M 52 x 2 | 41,0 | 57 | 50 |

Serija: LL = veoma lako L = lako S = teško – PN = nominalni pritisak PB = maks. radni pritisak – Ø d2 = spoljni prečnik cevi

Varijante proizvoda

| | |
|-------|--|
| XT VA | Navojni spoj, T oblik, plemeniti čelik |
| T | Navojni spoj, T oblik, čelik |