

# XWN VA

Uvrtni navojni spoj, ugao 90°

**HANSA FLEX**

## Osobine

Priključak 1	NPT spoljni navoj
Oblik zaptivke 1	zaptivanje preko navoja
Priključak 2	metrički spoljni cilindrični navoj
Oblik zaptivke 2	24° unutrašnji konus
Konstrukcija	Uvrtni navojni spoj
Konstrukcija	ugao 90°
Norma	DIN 2353 ISO 8434-1
Obim isporuke	Nastavak (bez preklopne navrtke i reznog prstena)
Materijal	plemeniti čelik

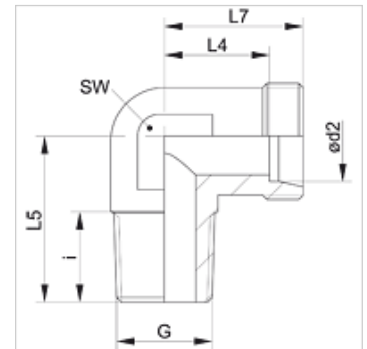

## Napomena

Molimo Vas da napomene za montažu, ugradnju, opterećenje pod pritiskom i dozvoljene radne temperature nađete u tehničkim informacijama o navojnim spojevima za cevi.

## Artikal

Naziv	Seriya	Radni pritisak bar	Cev spolja Ø (mm)	G	i (mm)	L4 (mm)	L5 (mm)	L7 (mm)	SW (mm)
XWN 04 LL VA	LL	PN 100	4	1/8" -27 NPT	8,0	11,0	17,0	15,0	9
XWN 06 LL VA	LL	PN 100	6	1/8" -27 NPT	8,0	9,5	17,0	15,0	9
XWN 08 LL VA	LL	PN 100	8	1/8" -27 NPT	10,0	11,5	20,0	17,0	12
XWN NW 04 HL VA	L	PN 315	6	1/8" -27 NPT	10,0	12,0	20,0	19,0	12
XWN NW 04 HL 1/4 VA	L	PN 315	6	1/4" -18 NPT	12,0	14,0	26,0	21,0	12
XWN NW 04 HL 3/8 VA	L	PN 315	6	3/8" -18 NPT	15,3	12,0	28,0	19,0	14
XWN NW 04 HL 1/2 VA	L	PN 315	6	1/2" -14 NPT	17,0	23,0	34,0	30,0	19
XWN NW 06 HL 1/8 VA	L	PN 315	8	1/8" -27 NPT	10,0	14,0	20,0	21,0	12
XWN NW 06 HL VA	L	PN 315	8	1/4" -18 NPT	12,0	14,0	26,0	21,0	12
XWN NW 06 HL 3/8 VA	L	PN 315	8	3/8" -18 NPT	15,2	11,5	20,0	18,5	12
XWN NW 06 HL 1/2 VA	L	PN 315	8	1/2" -14 NPT	17,5	15,0	26,0	22,0	12
XWN NW 08 HL 1/8 VA	L	PN 315	10	1/8" -27 NPT	10,0	15,0	22,5	22,0	14
XWN NW 08 HL VA	L	PN 315	10	1/4" -18 NPT	14,0	15,0	27,0	22,0	14
XWN NW 08 HL 3/8 VA	L	PN 315	10	3/8" -18 NPT	15,2	15,0	27,0	22,0	14
XWN NW 08 HL 1/2 VA	L	PN 315	10	1/2" -14 NPT	20,0	21,0	34,0	28,0	19
XWN NW 10 HL 1/4 VA	L	PN 315	12	1/4" -18 NPT	14,0	17,0	28,0	24,0	17
XWN NW 10 HL VA	L	PN 315	12	3/8" -18 NPT	12,5	17,0	28,0	24,0	17
XWN NW 13 HL 3/8 VA	L	PN 315	15	3/8" -18 NPT	13,0	21,0	34,0	28,0	19
XWN NW 10 HL 1/2 VA	L	PN 315	12	1/2" -14 NPT	19,0	23,0	34,0	30,0	19
XWN NW 13 HL VA	L	PN 315	15	1/2" -14 NPT	18,5	21,0	34,0	28,0	19
XWN NW 16 HL 3/8 VA	L	PN 315	18	3/8" -18 NPT	15,3	23,5	31,0	31,0	24
XWN NW 16 HL VA	L	PN 315	18	1/2" -14 NPT	20,0	23,5	36,0	31,0	24
XWN NW 16 HL 3/4 VA	L	PN 315	18	3/4" -14 NPT	18,5	23,5	40,0	31,0	24
XWN NW 20 HL 1/2 VA	L	PN 160	22	1/2" -14 NPT	20,0	27,5	42,0	35,0	27
XWN NW 20 HL VA	L	PN 160	22	3/4" -14 NPT	18,5	27,5	42,0	35,0	27
XWN NW 25 HL 3/4 VA	L	PN 160	28	3/4" -14 NPT	20,0	30,5	44,0	38,0	36
XWN NW 25 HL VA	L	PN 160	28	1" -11,5 NPT	24,0	30,5	48,0	38,0	36
XWN NW 32 HL VA	L	PN 160	35	1.1/4" -11,5 NPT	25,5	34,5	54,0	45,0	41
XWN NW 40 HL VA	L	PN 160	42	1.1/2" -11,5 NPT	26,0	40,0	61,0	51,0	50
XWN NW 03 HS VA	S	PN 630	6	1/4" -18 NPT	12,0	16,0	26,0	23,0	12
XWN NW 03 HS 3/8 VA	S	PN 630	6	3/8" -18 NPT	15,3	16,0	28,0	23,0	14
XWN NW 03 HS 1/2 VA	S	PN 630	6	1/2" -14 NPT	20,0	16,0	34,0	23,0	19
XWN NW 04 HS VA	S	PN 630	8	1/4" -18 NPT	15,0	17,0	27,0	24,0	14
XWN NW 04 HS 3/8 VA	S	PN 630	8	3/8" -18 NPT	15,3	17,0	28,0	24,0	14
XWN NW 04 HS 1/2 VA	S	PN 630	8	1/2" -14 NPT	20,0	17,0	34,0	24,0	19
XWN NW 06 HS 1/4 VA	S	PN 630	10	1/4" -18 NPT	15,0	17,5	27,0	25,0	17
XWN NW 06 HS VA	S	PN 630	10	3/8" -18 NPT	12,0	17,5	28,0	25,0	17
XWN NW 06 HS 1/2 VA	S	PN 630	10	1/2" -14 NPT	20,0	21,5	32,0	29,0	19
XWN NW 08 HS 1/4 VA	S	PN 630	12	1/4" -18 NPT	15,0	21,5	27,0	29,0	17
XWN NW 08 HS VA	S	PN 630	12	3/8" -18 NPT	12,5	21,5	28,0	29,0	17
XWN NW 08 HS 1/2 VA	S	PN 630	12	1/2" -14 NPT	20,0	21,5	34,0	29,0	19
XWN NW 10 HS VA	S	PN 630	14	1/2" -14 NPT	18,0	22,0	34,0	30,0	19



Uprkos pažljivom proveravanju, ne možemo isključiti greške i ne preuzimamo nikakvu garanciju za navedene podatke.

23.07.2024

HANSA-FLEX AG

www.hansa-flex.com

1

# XWN VA

Uvrtni navojni spoj, ugao 90°



## Artikal

Naziv	Serija	Radni pritisak bar	Cev spolja Ø (mm)	G	i (mm)	L4 (mm)	L5 (mm)	L7 (mm)	SW (mm)
XWN NW 10 HS 3/8 VA	S	PN 630	14	3/8" -18 NPT	15,3	22,0	30,0	30,0	19
XWN NW 13 HS VA	S	PN 400	16	1/2" -14 NPT	19,0	24,5	36,0	33,0	24
XWN NW 13 HS 3/8 VA	S	PN 400	16	3/8" -18 NPT	15,3	24,5	28,0	33,0	24
XWN NW 13 HS 3/4 VA	S	PN 400	16	3/4" -14 NPT	20,0	24,5	40,0	33,0	24
XWN NW 16 HS VA	S	PN 400	20	3/4" -14 NPT	20,0	26,6	42,0	37,0	27
XWN NW 16 HS 1/2 VA	S	PN 400	20	1/2" -14 NPT	20,0	26,5	42,0	37,0	27
XWN NW 20 HS VA	S	PN 400	25	1" -11,5 NPT	24,0	30,0	48,0	42,0	36
XWN NW 25 HS VA	S	PN 400	30	1.1/4" -11,5 NPT	25,5	35,5	54,0	49,0	41
XWN NW 32 HS VA	S	PN 315	38	1.1/2" -11,5 NPT	26,0	41,0	61,0	57,0	50

Serija: LL = veoma lako L = lako S = teško - PN = nominalni pritisak PB = maks. radni pritisak - Ø d2 = spoljni prečnik cevi

## Varijante proizvoda

XWN	Uvrtni navojni spoj, ugao 90°, čelik
WN VA	Uvrtni navojni spoj, ugao 90°, plemeniti čelik