

# SRS 1-6 IS V4

Imbus vijak, cevna objumica

**HANSA FLEX**

## Osobine

Konstrukcija	za cevnu objumicu
Seriya	lak
Norma	DIN 912 (ISO 4762)
Obim isporuke	sa podloškom
Materijal	plemeniti čelik 1.4571

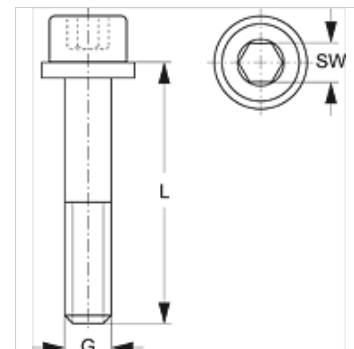

## Artikal

Naziv	Veličina objumice	G	L (mm)	SW (mm)
SRS IS 1 V4	0 - 1	M 6	20	5
SRS IS 2 V4	2	M 6	25	5
SRS IS 3 V4	3	M 6	30	5
SRS IS 4 V4	4	M 6	35	5
SRS IS 5 V4	5	M 6	50	5
SRS IS 6 V4	6	M 6	60	5

## Varijante proizvoda

SRS 1-6 IS Imbus vijak, cevna objumica, čelik