

KLEMMSCHEL

Clamp, Aluminium

HANSA FLEX

Osobine

| | |
|---------------------------|--|
| Primena | Clamping components for small flange connections |
| Verzija | Clamp aluminum |
| Norma | DIN 28403 ISO 2861 |
| Materijal | Aluminijum |
| Temperaturni opseg | Aluminijum od -156 °C do 150 °C |

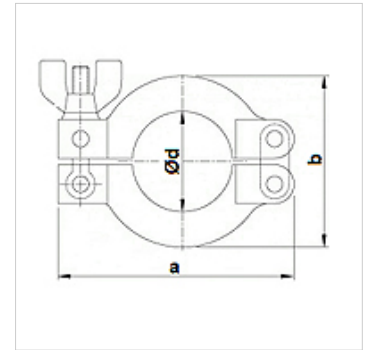

Napomena

Opseg pritiska od 10–7 mbar do 2,5 bar

Napomene u vezi porudžbine

Ostali modeli na zahtev

Artikal

| Naziv | Šrina (mm) | a (mm) | b (mm) | Ø d (mm) |
|-------------------|---------------|-----------|-----------|-------------|
| KLEMMSCHEL 010/16 | 17,0 | 63,0 | 45,0 | 22,0 |
| KLEMMSCHEL 020/25 | 17,0 | 73,0 | 52,0 | 32,0 |
| KLEMMSCHEL 032/40 | 17,0 | 93,0 | 70,0 | 47,0 |
| KLEMMSCHEL 050 | 22,0 | 114,0 | 95,0 | 62,0 |