

K-DRUCKSCHALTER VAKUUM

Combined vacuum/pressure switch

HANSA FLEX

Osobine

Konstrukcija	PNP
Priključak medija za merenje	G 1/8 male and M 5 female
Histereza	Adjustable: 3 to 25% of set value
Temperaturni opseg	0 - 50 °C
Mediji	Non-aggressive gases. dry, oil-free air
Kućište	Polycarbonate
Izlazni signal	Analogue: 1 to 5 V
Priključak na električnu mrežu	Male connector M8, four pin
Sposobnost komutacije	125 mA
Potrošnja struje	30 mA
Indikator stanja	LED

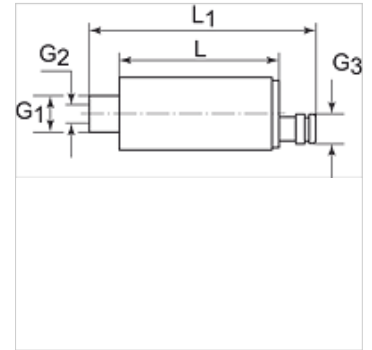
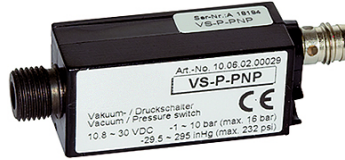

Napomena

Ostali podaci na upit.

Opis

Universal electronic vacuum and pressure switch for safety monitoring, optimisation of cycle times and regulation circuits. Its small size and low weight permit installation directly at the point of use. Suitable for all special applications in the vacuum and compressed air sectors. Adjustable vacuum limit value and continuous vacuum monitoring.

Artikal

Naziv	G1 spolja	G2 unutra	G3 spolja	L (mm)	L1 (mm)	Merni opseg	Napon
K- 07 45 01 31	G 1/8	M 5	M 8 x 1	44,0	62,0	-1 bis +10 bar	10.8 - 30 V DC