

K-DRV

Unidirectional flow control valves

Osobine

Radni pritisak	maks. 10 bara
Radna temperatura	max. +70 °C
Zaptivni materijal	NBR
Kućište	Alu eloxed
Unutrašnji delovi	Brass

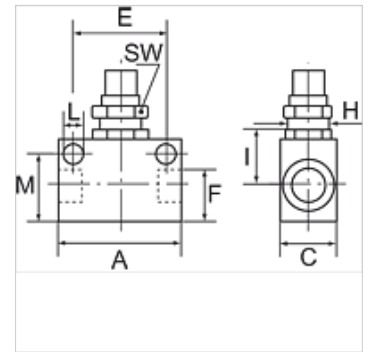

Napomena

Ostali podaci na upit.

Opis

These valves are restricted in the flow direction and have free passage in the opposite direction.

Artikal

Naziv	Navoj	A (mm)	C (mm)	E (mm)	H dimenzija	I (mm)	L (mm)	M (mm)	SW (mm)
K- 07 30 12 36	M 5	25,0	12,0	18,0	M 9 x 0.75 mm	10,0	3,2	12,2	11
K- 07 30 12 37	G 1/8	34,0	16,0	24,0	M 12 x 0.75 mm	15,0	4,5	16,4	15
K- 07 30 12 38	G 1/4	50,0	25,0	35,0	M 18 x 1.5 mm	24,0	6,5	23,8	22
K- 07 30 12 39	G 3/8	58,0	25,0	40,0	M 18 x 1.5 mm	24,0	6,5	25,3	22
K- 07 30 12 40	G 1/2	65,0	30,0	50,0	M 22 x 1.5 mm	29,0	6,5	33,0	26