

# K-DRS ELK GERAETESTECKER

Pressure switches, connection with plug connector, type A acc. to DIN 43650

**HANSA FLEX**

## Osobine

Oblast primene	Pneumatic applications
Učestalost komutacije	200/min.
Napon komutacije	max. 250 V AC / 28 V DC
Vrsta zaštite	IP 65 (DIN 43650), IP 67 (M 12 x 1)
Temperaturni opseg	-10 °C to +80 °C
Poklopac za podešavanje	Aluminium, powder-coated
Kučište	Special die-cast material
Membrana, zaptivka	NBR

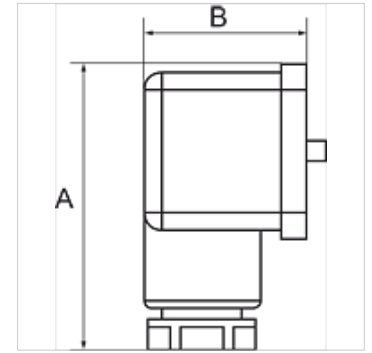

## Napomena

Ostali podaci na upit.

## Opis

For converting pneumatic to electrical signals. Designed for use in rough vacuum applications (technical vacuum). Universal switch type, suitable as NC, NO or changeover contact. These devices are free from paint-wetting impairment substances (PWIS).

## Artikal

Naziv	Priključak	Opseg podešavanja	A (mm)	B (mm)
K- 07 30 28 45	G 1/4	0,2 - 2,0 bar	48,0	28,0
K- 07 30 28 46	G 1/4	0,5 - 8,0 bar	48,0	28,0
K- 07 30 28 47	G 1/4	1,0 - 16,0 bar	48,0	28,0