

# K-DRS ELK ANSCHLUSS M 1

Pressure switches, electrical connection M 12 x 1

## Osobine

|                         |                                     |
|-------------------------|-------------------------------------|
| Oblast primene          | Pneumatic applications              |
| Učestalost komutacije   | 200/min.                            |
| Napon komutacije        | max. 250 V AC / 28 V DC             |
| Vrsta zaštite           | IP 65 (DIN 43650), IP 67 (M 12 x 1) |
| Temperaturni opseg      | -10 °C to +80 °C                    |
| Poklopac za podešavanje | Aluminium, powder-coated            |
| Kućište                 | Special die-cast material           |
| Membrana, zaptivka      | NBR                                 |

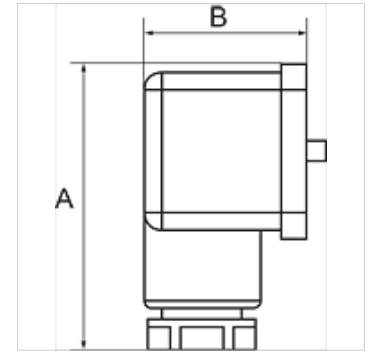

## Napomena

Ostali podaci na upit.

## Opis

For converting pneumatic to electrical signals. Designed for use in rough vacuum applications (technical vacuum). Universal switch type, suitable as NC, NO or changeover contact. These devices are free from paint-wetting impairment substances (PWIS).

## Artikal

| Naziv          | Priključak | Opseg podešavanja | A<br>(mm) | B<br>(mm) |
|----------------|------------|-------------------|-----------|-----------|
| K- 07 30 28 48 | G 1/4      | 0,2 - 2,0 bar     | 48,0      | 28,0      |
| K- 07 30 28 49 | G 1/4      | 0,5 - 8,0 bar     | 48,0      | 28,0      |
| K- 07 30 28 50 | G 1/4      | 1,0 - 16,0 bar    | 48,0      | 28,0      |