

K-VHR 6KT ES

Hexagon head screw plugs

Osobine

Radni pritisak	Max. 20 bar
Konstrukcija	Zavrtanj za zatvaranje, sa spoljašnjim šestougaonikom
Materijal	plemeniti čelik 1.4571

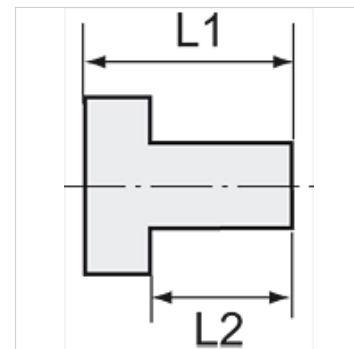
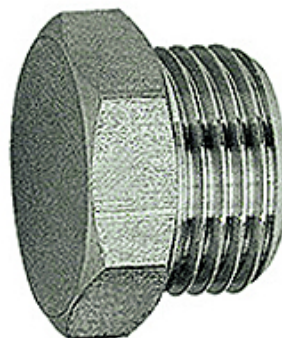

Napomena

The dimensions of the standard screw fittings may change slightly during the life of the catalogue as a result of optimisation processes.
Ostali podaci na upit.

Dodatne informacije

Further types and dimensions on request.

Artikal

Naziv	Navoj	L1 (mm)	L2 (mm)	SW
K- 07 40 39 69	G 1/8	11,0	6,0	13 mm
K- 07 40 39 70	G 1/4	13,0	8,0	17 mm
K- 07 40 39 71	G 3/8	14,0	8,0	19 mm
K- 07 40 39 72	G 1/2	16,0	10,0	24 mm
K- 07 40 45 28	G 3/4	16,0	11,0	30 mm
K- 07 40 44 43	G 1	19,0	13,0	38 mm