

# K-L-STECKVER ABSP DREH AG OR

Angle stop valves, swivel type, parallel male thread with O-ring

**HANSA FLEX**

## Osobine

Radni pritisak	Max. 10 bar, vacuum
Oblast primene	Air, vacuum
preporučena creva	PU or PA (nylon)
Mediji	Komprimovani vazduh
Norma	G thread acc. to DIN EN ISO 228-1, with O-Ring
Temperaturni opseg	0 °C to +60 °C
Zaptivna površina	O-ring (NBR)
Materijal	Plastic, Nickel plated brass
Pritisni prsten	Plastic

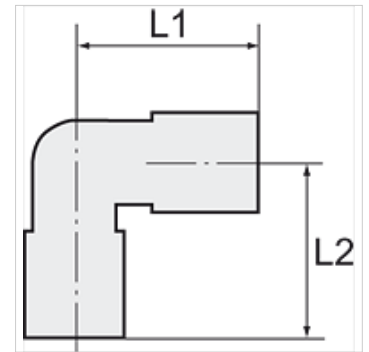

## Napomena

Ostali podaci na upit.

## Opis

The air supply is completely shut off as soon as the hose is disconnected from the union. <br>The flow rate is only guaranteed if the hose is securely inserted.

## Artikal

Naziv	Navoj	Ø mm za crevo spolja	L1 (mm)	L2 (mm)	SW
K- 07 40 08 46	M 5	4 mm	31,0	21,3	10 mm
K- 07 40 08 47	M 5	6 mm	29,4	21,7	12 mm
K- 07 40 08 40	G 1/8	4 mm	31,0	24,3	14 mm
K- 07 40 08 41	G 1/8	6 mm	29,4	24,2	14 mm
K- 07 40 08 42	G 1/8	8 mm	33,0	27,0	14 mm
K- 07 40 08 38	G 1/4	6 mm	29,4	26,7	17 mm
K- 07 40 08 39	G 1/4	8 mm	33,0	29,5	17 mm
K- 07 40 08 37	G 1/4	10 mm	42,5	34,3	17 mm
K- 07 40 08 45	G 3/8	8 mm	33,0	30,0	20 mm
K- 07 40 08 43	G 3/8	10 mm	42,5	34,3	20 mm
K- 07 40 08 44	G 3/8	12 mm	46,5	36,0	21 mm
K- 07 40 08 35	G 1/2	10 mm	42,5	37,8	24 mm
K- 07 40 08 36	G 1/2	12 mm	46,5	39,0	24 mm