

K-L-STECKVER ABSP DREH AG-K

Angle stop valves, swivel type, conical male thread, coated

HANSA FLEX

Osobine

Radni pritisak	Max. 10 bar, vacuum
Oblast primene	Air, vacuum
preporučena creva	PU or PA (nylon)
Mediji	Komprimovani vazduh
Norma	R thread acc. to ISO 7-1, thread coating
Temperaturni opseg	0 °C to +60 °C
Zaptivna površina	Conical version: thread coating
Materijal	Plastic, Nickel plated brass
Pritisni prsten	Plastic

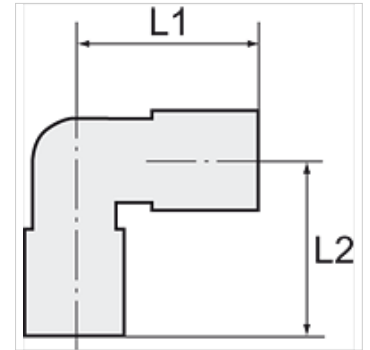

Napomena

Ostali podaci na upit.

Opis

The air supply is completely shut off as soon as the hose is disconnected from the union. The flow rate is only guaranteed if the hose is securely inserted.

Artikal

Naziv	Navoj	Ø mm za crevo spolja	L1 (mm)	L2 (mm)	SW
K- 07 40 08 53	R 1/8	4 mm	31,0	23,8	10 mm
K- 07 40 08 54	R 1/8	6 mm	29,4	24,2	12 mm
K- 07 40 08 55	R 1/8	8 mm	33,0	27,5	14 mm
K- 07 40 08 51	R 1/4	6 mm	29,4	26,7	14 mm
K- 07 40 08 52	R 1/4	8 mm	33,0	29,5	14 mm
K- 07 40 08 50	R 1/4	10 mm	42,5	34,3	17 mm
K- 07 40 08 58	R 3/8	8 mm	33,0	31,0	17 mm
K- 07 40 08 56	R 3/8	10 mm	42,5	35,3	17 mm
K- 07 40 08 57	R 3/8	12 mm	46,5	37,0	21 mm
K- 07 40 08 48	R 1/2	10 mm	42,5	38,8	21 mm
K- 07 40 08 49	R 1/2	12 mm	46,5	40,0	21 mm