

K-W90 STUECK IG IG VA

Elbows, female/female, stainless steel

HANSA FLEX

Osobine

Radna temperatura -20 °C to +150 °C

Područje pritiska Max. 150 bar

Unutrašnji navoj Parallel to DIN EN ISO 228-1

Materijal Plemeniti čelik 1.4404

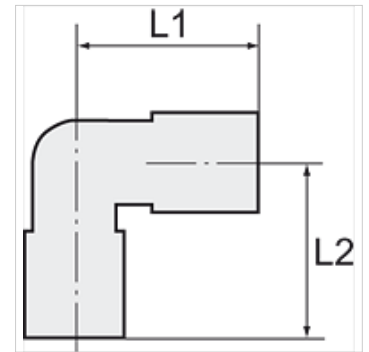

Napomena

Ostali podaci na upit.

Artikal

Naziv	Navoj	L1 (mm)	L2 (mm)
K- 07 40 10 64	G 1/8	19,0	19,0
K- 07 40 10 65	G 1/4	23,0	23,0
K- 07 40 10 66	G 3/8	25,5	25,5
K- 07 40 10 67	G 1/2	32,0	32,0