

K-W90 SCHLAUCH VB PFA

Elbow hose connectors - Perfluoroalkoxy alkane (PFA)

HANSA FLEX

Osobine

Radni pritisak	Dependent on operating temperature; Max. 10 bar (at 20 °C); Max. 1 bar (at 170 °C)
Radna temperatura	Max. 200 °C
Materijal	Perfluoroalkoxy alkane (PFA)

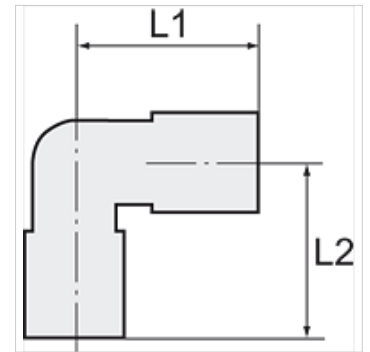

Napomena

Ostali podaci na upit.

Opis

Perfluoroalkoxy alkane (PFA): A fluoroplastic (PTFE) with the same chemical resistance as PTFE but much stronger and suitable for temperatures up to 200°C.

Artikal

Naziv	za crevo	L1 (mm)	L2 (mm)
K- 07 40 41 58	4 mm / 6 mm	25,0	25,0
K- 07 40 41 60	6 mm / 8 mm	30,0	30,0
K- 07 40 41 62	8 mm / 10 mm	36,0	36,0