

K-STECKVERSCH AGR OR SK M O

Male connectors, parallel male thread with O-ring and outer hex

HANSA FLEX

Osobine

Radni pritisak	Max. 16 bar
Radna temperatura	-20 °C to +80 °C
Materijal	Mesing, niklovan
Pritisni prsten	Hostaform
O-prsten	NBR
Stezni prsten	Stainless steel

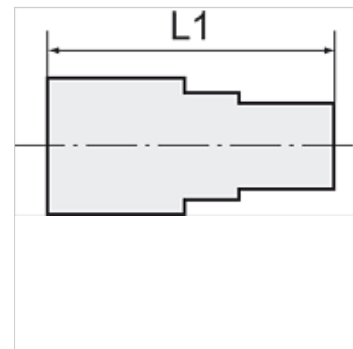
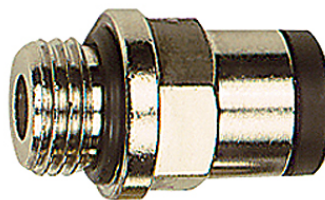

Napomena

Ostali podaci na upit.

Opis

The advanced version of our highly successful push-in fittings series manufactured in nickel-plated brass. Advantages of this new, optimised series: Much easier connection and disconnection of the hose, even with repeated mounting, can also be used for non-calibrated hoses, suitable for vacuum operation.

Artikal

Naziv	Navoj	Ø mm za crevo spolja	Imbus (mm)	L1 (mm)	SW
K- 07 40 24 82	M 3	3 mm	1,5	12,6	Ø 5,8 mm
K- 07 40 24 83	M 5	3 mm	2,0	13,0	Ø 5,8 mm
K- 07 40 24 84	M 5	4 mm	2,5	20,3	Ø 9 mm
K- 07 40 24 85	M 5	5 mm	2,5	22,5	Ø 12 mm
K- 07 40 24 86	M 5	6 mm	2,5	21,9	Ø 11 mm
K- 07 40 24 87	M 7	4 mm	3,0	18,9	Ø 9 mm
K- 07 40 24 88	M 7	6 mm	4,0	23,0	Ø 11 mm
K- 07 40 24 98	G 1/8	4 mm	3,0	18,0	10 mm
K- 07 40 24 99	G 1/8	5 mm	3,0	22,0	13 mm
K- 07 40 25 00	G 1/8	6 mm	4,0	21,6	12 mm
K- 07 40 25 01	G 1/8	8 mm	5,0	25,4	13 mm
K- 07 40 24 94	G 1/4	4 mm	3,0	19,8	10 mm
K- 07 40 24 95	G 1/4	5 mm	3,0	24,0	12 mm
K- 07 40 24 96	G 1/4	6 mm	4,0	20,3	12 mm
K- 07 40 24 97	G 1/4	8 mm	6,0	24,4	14 mm
K- 07 40 24 92	G 1/4	10 mm	7,0	29,2	16 mm
K- 07 40 24 93	G 1/4	12 mm	7,0	30,5	19 mm
K- 07 40 25 05	G 3/8	8 mm	6,0	22,8	14 mm
K- 07 40 25 02	G 3/8	10 mm	8,0	26,5	16 mm
K- 07 40 25 03	G 3/8	12 mm	10,0	28,1	19 mm
K- 07 40 25 04	G 3/8	14 mm	10,0	33,8	22 mm
K- 07 40 24 89	G 1/2	10 mm	8,0	29,8	16 mm
K- 07 40 24 90	G 1/2	12 mm	10,0	29,3	19 mm
K- 07 40 24 91	G 1/2	14 mm	12,0	31,5	22 mm