

# K-STECKNIPPEL

push-in plug

**HANSA FLEX**

## Osobine

Radni pritisak	Max. 16 bar
Radna temperatura	-20 °C to +80 °C
Materijal	Mesing, niklovan

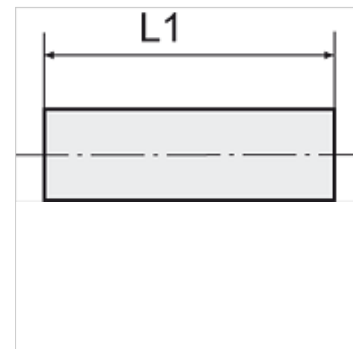
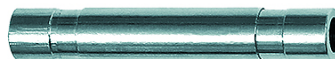

## Napomena

Ostali podaci na upit.

## Opis

The advanced version of our highly successful push-in fittings series manufactured in nickel-plated brass. Advantages of this new, optimised series: Much easier connection and disconnection of the hose, even with repeated mounting, can also be used for non-calibrated hoses, suitable for vacuum operation.

## Artikal

Naziv	Ø mm za crevo spolja	L1 (mm)
K- 07 40 47 53	4 mm	34,0
K- 07 40 47 54	5 mm	34,0
K- 07 40 47 55	6 mm	37,5
K- 07 40 47 56	8 mm	37,5
K- 07 40 47 57	10 mm	45,0
K- 07 40 47 58	12 mm	48,0
K- 07 40 47 59	14 mm	58,0