

K-TUE IG ES

Female hose fittings with female thread stainless steel

HANSA FLEX

Osobine

Radni pritisak Max. 20 bar

Materijal plemeniti čelik 1.4571

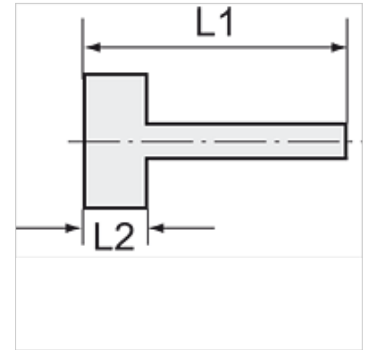
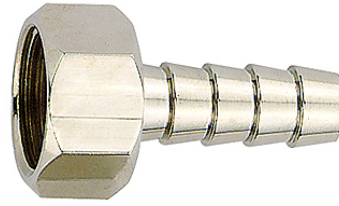

Napomena

The dimensions of the standard screw fittings may change slightly during the life of the catalogue as a result of optimisation processes.

Ostali podaci na upit.

Dodatne informacije

Further types and dimensions on request.

Artikal

Naziv	Navoj	za crevo	L1 (mm)	L2 (mm)	SW
K- 07 40 13 30	G 1/8	LW 6 mm	35,0	10,0	12 mm
K- 07 40 13 31	G 1/8	LW 8 mm	35,0	10,0	12 mm
K- 07 40 13 32	G 1/4	LW 6 mm	36,0	11,0	17 mm
K- 07 40 13 33	G 1/4	LW 8 mm	36,0	11,0	17 mm
K- 07 40 13 34	G 1/4	LW 10 mm	36,0	11,0	17 mm
K- 07 40 13 35	G 1/4	LW 13 mm	40,5	11,0	17 mm
K- 07 40 13 36	G 3/8	LW 6 mm	36,0	11,0	19 mm
K- 07 40 13 37	G 3/8	LW 8 mm	36,0	11,0	19 mm
K- 07 40 13 38	G 3/8	LW 10 mm	36,0	11,0	19 mm
K- 07 40 13 39	G 3/8	LW 13 mm	40,5	11,0	19 mm
K- 07 40 13 40	G 1/2	LW 6 mm	39,0	14,5	24 mm
K- 07 40 13 41	G 1/2	LW 8 mm	39,0	14,5	24 mm
K- 07 40 13 42	G 1/2	LW 10 mm	39,0	14,5	24 mm
K- 07 40 13 43	G 1/2	LW 13 mm	44,0	14,5	24 mm