

WF LK M

Pompa Flanş, 4 Delikli, 90° Açılı

HANSA FLEX

Özellikler

Model	Pompa Flanş, 4 delikli
Dizayn	90° Açılı
Standart	DIN 3901/3902
Sabitlenme	metrik vida setli
Teslimat kapsamı	vida setli, conta halkalı, somunlu ve kesme halkalı
Malzeme	Temper döküm GTW40
Yüzey koruması	galvaniz kaplı

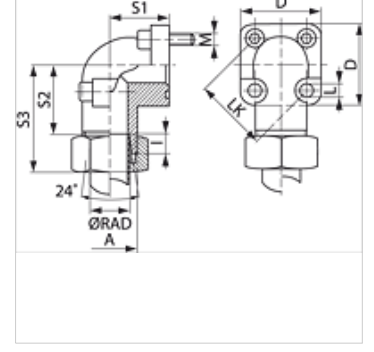

Ürün

Tanım	Tip	I	Ø RAD	Basınç PB	A	LK	TR	S1	S2	S3	L	Vidalar 1	Vidalar 2	OR
			(mm)	(mm)	(bar)	(mm)	(mm)	(mm)	(mm)	(mm)	(mm)			
WF 35 LK L 10 315 M	L	14,0	10	315	M16x1,5	35	39	16,5	30,5	47,0	6,4	(2x) M 6 x 22	(2x) M 6 x 35	20,0 x 2,5
WF 35 LK L 12 315 M	L	14,0	12	315	M18x1,5	35	39	16,5	30,5	47,0	6,4	(2x) M 6 x 22	(2x) M 6 x 35	20,0 x 2,5
WF 35 LK L 15 250 M	L	14,0	15	250	M22x1,5	35	39	16,5	30,0	46,0	6,4	(2x) M 6 x 22	(2x) M 6 x 35	20,0 x 2,5
WF 35 LK L 18 250 M	L	15,0	18	250	M26x1,5	35	39	20,0	30,0	47,5	6,4	(2x) M 6 x 22	(2x) M 6 x 40	20,0 x 2,5
WF 40 LK L 15 100 M	L	20,0	15	100	M22x1,5	40	42	22,5	30,0	46,0	6,4	(2x) M 6 x 22	(2x) M 6 x 45	26,0 x 2,5
WF 40 LK L 18 100 M	L	20,0	18	100	M26x1,5	40	42	22,5	30,5	47,0	6,4	(2x) M 6 x 22	(2x) M 6 x 45	26,0 x 2,5
WF 40 LK L 22 100 M	L	20,0	22	100	M30x2	40	42	22,5	30,5	47,5	6,4	(2x) M 6 x 22	(2x) M 6 x 45	26,0 x 2,5
WF 40 LK L 28 100 M	L	20,0	28	100	M36x2	40	42	28,0	32,5	49,0	6,4	(2x) M 6 x 22	(2x) M 6 x 50	26,0 x 2,5
WF 40 LK L 35 100 M	L	20,0	35	100	M45x2	40	42	34,0	30,5	52,0	6,4	(2x) M 6 x 22	(2x) M 6 x 60	26,0 x 2,5
WF 55 LK L 35 100 M	L	26,0	35	100	M45x2	55	58	32,0	38,5	62,0	8,4	(2x) M 8 x 25	(2x) M 8 x 60	32,0 x 2,5
WF 55 LK L 42 100 M	L	26,0	42	100	M52x2	55	58	40,0	38,0	61,0	8,4	(2x) M 8 x 25	(2x) M 8 x 70	32,0 x 2,5
WF 35 LK S 16 315 M	S	15,0	16	315	M24x1,5	35	39	20,0	29,5	48,0	6,4	(2x) M 6 x 22	(2x) M 6 x 40	20,0 x 2,5
WF 35 LK S 20 315 M	S	15,0	20	315	M30x2	35	39	25,0	34,5	56,0	6,4	(2x) M 6 x 22	(2x) M 6 x 45	20,0 x 2,5
WF 40 LK S 20 250 M	S	20,0	20	250	M30x2	40	42	22,5	29,5	50,0	6,4	(2x) M 6 x 22	(2x) M 6 x 45	26,0 x 2,5
WF 55 LK S 20 250 M	S	18,0	20	250	M30x2	55	58	24,0	34,5	56,0	8,4	(2x) M 8 x 25	(2x) M 8 x 50	32,0 x 2,5
WF 55 LK S 25 250 M	S	20,0	25	250	M36x2	55	58	30,0	37,0	61,0	8,4	(2x) M 8 x 25	(2x) M 8 x 55	32,0 x 2,5
WF 55 LK S 30 250 M	S	26,0	30	250	M42x2	55	58	32,0	35,5	62,0	8,4	(2x) M 8 x 25	(2x) M 8 x 50	32,0 x 2,5

Model: LL = Çok hafif L = Hafif S = Ağır - PN=Çalışma Basıncı PB=Patlama Basıncı - çap RAD = boru dış çapı için

Ürün türleri

WF LK Pompa Flanş, 4 Delikli, 90° Açılı, metrik vida setli ve o-ringli