

Özellikler

Bağlantı 1	BSP dış dış silindirik
Sızdırmazlık şekli 1	Form F
Bağlantı 2	metrik dış dış, silindirik
Sızdırmazlık şekli 2	24° içe havşalı
Model	Döner Dirsek kısıtlamasız
Dizayn	90° Açılı
Standart	DIN 2353 ISO 8434-1
Teslimat kapsamı	Gövde (Somun ve Yüzüklü)
Malzeme	Çelik
Yüzey koruması	galvaniz kaplı

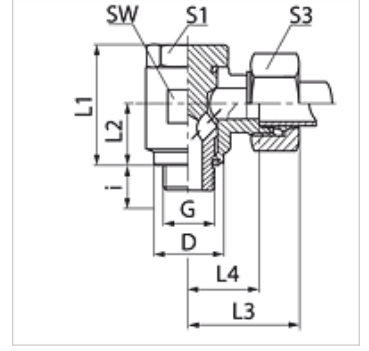

Açıklama

Montaj, Basınç Değeri ve izin verilen Çalışma Sıcaklıkları ile ilgili Bilgiler için Lütfen Boru Bağlantı Teknik Bilgilerine Bakınız.

Ürün

Tanım	Tip	Çalışma basıncı bar	Borunun dış çapı (mm)	G	TR	i	L1	L2	L3	L4	SW	S1	S3	OR
						(mm)	(mm)	(mm)	(mm)	(mm)	(mm)			
SDOR 04 LL	LL	PN 100	4	G 1/8" -28	14,7	8,0	23,5	10,5	29,0	14,0	17	17	10	7,65 x 1,78
SDOR 06 LL	LL	PN 100	6	G 1/8" -28	13,5	8,0	23,5	10,5	28,5	13,5	17	17	12	7,65 x 1,78
SDOR 08 LL	LL	PN 100	8	G 1/8" -28	14,7	8,0	23,5	10,5	28,5	13,5	17	17	14	7,65 x 1,78
SDOR NW 04 HL	L	PN 315	6	G 1/8" -28	14,0	8,0	24,0	10,5	27,0	12,0	17	17	14	7,65 x 1,78
SDOR NW 06 HL	L	PN 315	8	G 1/4" -19	18,0	12,0	30,0	14,0	29,0	14,5	22	19	17	11,10 x 1,78
SDOR NW 08 HL	L	PN 315	10	G 1/4" -19	18,0	12,0	30,0	14,0	30,0	15,5	22	19	19	11,10 x 1,78
SDOR NW 10 HL	L	PN 315	12	G 3/8" -19	22,0	12,0	36,0	16,5	33,0	18,0	27	24	22	14,00 x 1,78
SDOR NW 13 HL	L	PN 315	15	G 1/2" -14	26,0	14,0	45,0	21,5	37,0	21,5	32	30	27	18,77 x 1,78
SDOR NW 16 HL	L	PN 315	18	G 1/2" -14	26,0	14,0	45,0	21,5	37,0	21,0	32	30	32	18,77 x 1,78
SDOR NW 20 HL	L	PN 160	22	G 3/4" -14	32,0	16,0	53,0	24,0	44,0	27,5	41	36	36	23,81 x 2,62
SDOR NW 25 HL	L	PN 160	28	G 1" -11	39,0	18,0	66,0	30,5	49,0	32,0	50	46	41	29,82 x 2,62
SDOR NW 32 HL	L	PN 160	35	G 1.1/4" -11	49,0	20,0	76,0	35,5	58,0	36,0	60	55	50	37,77 x 2,62
SDOR NW 40 HL	L	PN 160	42	G 1.1/2" -11	55,0	22,0	87,0	40,5	63,0	40,5	70	60	60	41,28 x 3,53
SDOR NW 03 HS	S	PN 400	6	G 1/4" -19	18,0	12,0	30,0	14,0	31,0	16,5	22	19	17	11,10 x 1,78
SDOR NW 04 HS	S	PN 400	8	G 1/4" -19	18,0	12,0	30,0	14,0	31,0	16,5	22	19	19	11,10 x 1,78
SDOR NW 06 HS	S	PN 400	10	G 3/8" -19	22,0	12,0	36,0	16,5	35,0	18,5	27	24	22	14,00 x 1,78
SDOR NW 08 HS	S	PN 400	12	G 3/8" -19	22,0	12,0	36,0	16,5	35,0	18,5	27	24	24	14,00 x 1,78
SDOR NW 10 HS	S	PN 400	14	G 1/2" -14	26,0	14,0	45,0	21,5	40,0	22,5	32	30	27	18,77 x 1,78
SDOR NW 13 HS	S	PN 315	16	G 1/2" -14	26,0	14,0	45,0	21,5	40,0	22,0	32	30	30	18,77 x 1,78
SDOR NW 16 HS	S	PN 315	20	G 3/4" -14	32,0	16,0	53,0	24,0	48,0	26,5	41	36	36	23,81 x 2,62
SDOR NW 20 HS	S	PN 250	25	G 1" -11	39,0	18,0	66,0	30,5	56,0	31,5	50	46	46	29,82 x 2,62
SDOR NW 25 HS	S	PN 160	30	G 1.1/4" -11	49,0	20,0	76,0	35,5	64,0	37,0	60	55	50	37,77 x 2,62
SDOR NW 32 HS	S	PN 160	38	G 1.1/2" -11	55,0	22,0	87,0	40,5	72,0	41,5	70	60	60	41,28 x 3,53

PN=Çalışma Basıncı PB=Patlama Basıncı - Model: LL = Çok hafif L = Hafif S = Ağır - çap d2 = Boru dış çapı

Ürün türleri

SDOR VA	Döner Dirsek, Kısıtlamasız, 90° Açılı, Paslanmaz çelik
XSDOR	Döner Dirsek, Kısıtlamasız, 90° Açılı, Çelik