

Özellikler

Bağlantı 1	metrik dış diş, silindirik
Sızdırmazlık şekli 1	Form E
Bağlantı 2	metrik dış diş, silindirik
Sızdırmazlık şekli 2	24° içe havşalı
Model	Döner Dirsek kısıtlamasız
Dizayn	90° Açılı
Standart	DIN 2353 ISO 8434-1
Teslimat kapsamı	Gövde (somon ve yüzüksüz)
Malzeme	Çelik
Yüzey koruması	galvaniz kaplı

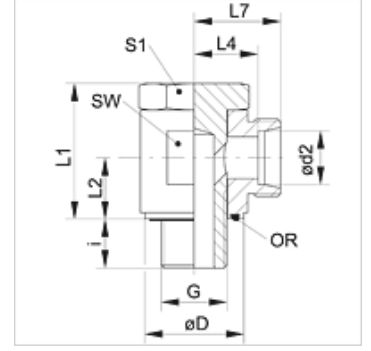

Açıklama

Montaj, Basınç Değeri ve izin verilen Çalışma Sıcaklıkları ile ilgili Bilgiler için Lütfen Boru Bağlantı Teknik Bilgilerine Bakınız.

Ürün

Tanım	Tip	Çalışma basıncı bar	Ø d2 (mm)	G	Ø D (mm)	i (mm)	L1 (mm)	L2 (mm)	L4 (mm)	L7 (mm)	SW (mm)	S1	OR
XSDOM 06 LL	LL	PN 100	6	M 10 x 1	14,5	8,0	23,5	10,5	13,5	19,0	17	17	7,65 x 1,78
XSDOM 08 LL	LL	PN 100	8	M 10 x 1	14,5	8,0	23,5	10,5	13,5	19,0	17	17	7,65 x 1,78
XSDOM NW 04 HL	L	PN 315	6	M 10 x 1	14,0	8,0	24,0	10,5	12,0	19,0	17	17	7,65 x 1,78
XSDOM NW 06 HL	L	PN 315	8	M 12 x 1,5	17,0	12,0	30,0	14,0	14,5	21,5	22	19	11,10 x 1,78
XSDOM NW 08 HL	L	PN 315	10	M 14 x 1,5	19,0	12,0	30,0	14,0	15,5	22,5	22	19	11,10 x 1,78
XSDOM NW 10 HL	L	PN 315	12	M 16 x 1,5	21,0	12,0	36,0	16,5	18,0	25,0	27	24	14,00 x 1,78
XSDOM NW 10 HL 18	L	PN 315	12	M 18 x 1,5	23,5	12,0	35,0	16,5	18,0	25,0	27	24	18,77 x 1,78
XSDOM NW 13 HL	L	PN 315	15	M 18 x 1,5	23,0	12,0	39,5	18,5	21,5	28,5	30	27	18,77 x 1,78
XSDOM NW 16 HL	L	PN 315	18	M 22 x 1,5	27,0	14,0	45,0	21,5	21,0	28,5	32	30	18,77 x 1,78
XSDOM NW 20 HL	L	PN 160	22	M 26 x 1,5	31,0	16,0	53,0	24,0	27,5	35,0	41	36	23,81 x 2,62
XSDOM NW 25 HL	L	PN 160	28	M 33 x 2	39,0	18,0	66,0	30,5	32,0	39,5	50	46	29,82 x 2,62
XSDOM NW 32 HL	L	PN 160	35	M 42 x 2	49,0	20,0	76,0	35,5	36,0	46,5	60	55	37,77 x 2,62
XSDOM NW 40 HL	L	PN 160	42	M 48 x 2	55,0	22,0	87,0	40,5	40,5	51,5	70	60	41,28 x 3,53
XSDOM NW 03 HS	S	PN 400	6	M 12 x 1,5	17,5	12,0	30,0	14,0	16,5	23,5	22	19	11,10 x 1,78
XSDOM NW 04 HS	S	PN 400	8	M 14 x 1,5	19,0	12,0	30,0	14,0	16,5	23,5	22	19	11,10 x 1,78
XSDOM NW 06 HS	S	PN 400	10	M 16 x 1,5	21,0	12,0	35,0	16,5	18,5	26,0	27	24	14,00 x 1,78
XSDOM NW 08 HS	S	PN 400	12	M 18 x 1,5	23,0	12,0	39,5	18,5	20,0	27,5	30	27	18,77 x 1,78
XSDOM NW 10 HS	S	PN 400	14	M 20 x 1,5	25,0	14,0	43,5	20,0	22,5	30,5	32	30	18,77 x 1,78
XSDOM NW 13 HS	S	PN 315	16	M 22 x 1,5	27,0	14,0	45,0	21,5	22,0	30,5	32	30	18,77 x 1,78
XSDOM NW 16 HS	S	PN 315	20	M 27 x 2	32,0	16,0	53,0	24,0	26,5	37,0	41	36	23,81 x 2,62
XSDOM NW 20 HS	S	PN 250	25	M 33 x 2	39,0	18,0	66,0	30,5	31,5	43,5	50	46	29,82 x 2,62
XSDOM NW 25 HS	S	PN 160	30	M 42 x 2	49,0	20,0	76,0	35,5	37,0	50,5	60	55	37,77 x 2,62
XSDOM NW 32 HS	S	PN 160	38	M 48 x 2	55,0	22,0	87,0	40,5	41,5	57,5	70	60	41,28 x 3,53

PN=Çalışma Basıncı PB=Patlama Basıncı - Model: LL = Çok hafif L = Hafif S = Ağır - çap = Boru dış çapı

Ürün türleri

XSDOM VA	Döner Dirsek, Kısıtlamasız, 90° Açılı, Paslanmaz çelik
SDOM	Döner Dirsek, Kısıtlamasız, 90° Açılı, Çelik