

# KLEMMSCHEL

Clamp, Aluminium

**HANSA FLEX**

## Özellikler

<b>Uygulama</b>	Clamping components for small flange connections
<b>Model</b>	Clamp aluminum
<b>Standart</b>	DIN 28403 ISO 2861
<b>Malzeme</b>	Alüminyum
<b>Sıcaklık sahası</b>	Alüminyum -156 °C'den 150 °C'ye kadar

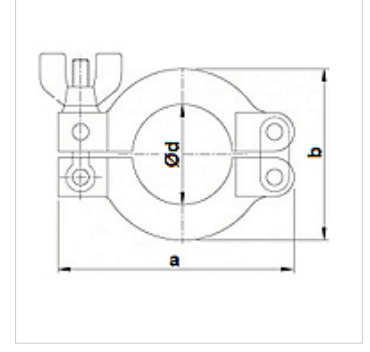

## Açıklama

10-7 mbar ile 2,5 bar arasındaki basınç aralığı

## Siparişe ilgili bilgiler

İstek halinde farklı modeller sunulabilir

## Ürün

Tanım	Genişlik (mm)	a (mm)	b (mm)	Ø d (mm)
KLEMMSCHEL 010/16	17,0	63,0	45,0	22,0
KLEMMSCHEL 020/25	17,0	73,0	52,0	32,0
KLEMMSCHEL 032/40	17,0	93,0	70,0	47,0
KLEMMSCHEL 050	22,0	114,0	95,0	62,0