

# K-DRS ELK ANSCHLUSS M 1

Pressure switches, electrical connection M 12 x 1

**HANSA FLEX**

## Özellikler

Kullanım Alanı	Pneumatic applications
Kumanda sıklığı	200/min.
Şalter gerilimi	max. 250 V AC / 28 V DC
Koruma sınıfı	IP 65 (DIN 43650), IP 67 (M 12 x 1)
Sıcaklık sahası	-10 °C to +80 °C
Ayar başlığı	Aluminium, powder-coated
Gövde	Special die-cast material
Membran, conta	NBR

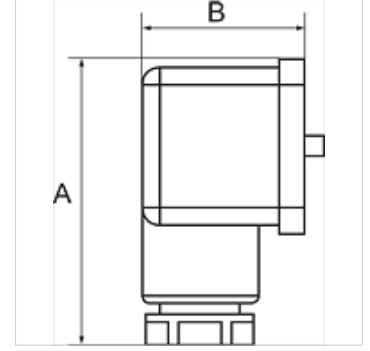

## Açıklama

Diğer bilgiler, istek üzerinedir.

## Açıklama

For converting pneumatic to electrical signals. Designed for use in rough vacuum applications (technical vacuum). Universal switch type, suitable as NC, NO or changeover contact. These devices are free from paint-wetting impairment substances (PWIS).

## Ürün

Tanım	Bağlantı	Ayarlama alanı	A (mm)	B (mm)
K- 07 30 28 48	G 1/4	0,2 - 2,0 bar	48,0	28,0
K- 07 30 28 49	G 1/4	0,5 - 8,0 bar	48,0	28,0
K- 07 30 28 50	G 1/4	1,0 - 16,0 bar	48,0	28,0