

### Özellikler

Çalışma basıncı	Max. 16 bar (at +20 °C)
İşletim ısısı	-20 °C to +70 °C
Malzeme	Nikel kaplı pirinç
Bastırma halkası	Hostaform (black nickel-plated for Ø 10, 12)
Conta halkası	NBR, siliconefree
Gerdirme pensesi	Stainless steel AISI 316

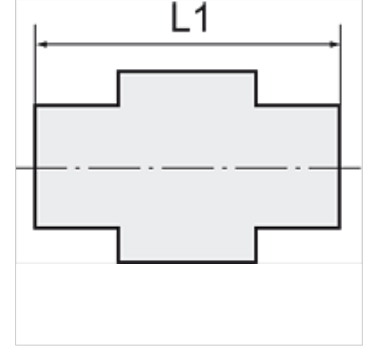
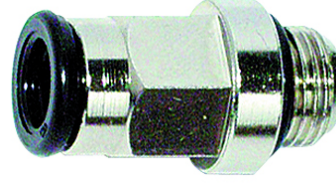

### Açıklama

Diğer bilgiler, istek üzerinedir.

### Açıklama

Economy yet very high-quality series of push-in fittings made of nickel-plated brass. Compact, space-saving, lightweight design. An O-ring in the fillet at the end of the thread guarantees a tight connection for all male thread parts, even on rough surfaces.

### Ürün

Tanım	Mil	Hortumun dış çapı için	L1 (mm)	SW
K- 07 40 29 22	M 5	4 mm	20,5	-
K- 07 40 29 23	M 5	6 mm	22,5	-
K- 07 40 29 30	G 1/8	4 mm	20,0	9.0 mm
K- 07 40 29 31	G 1/8	6 mm	24,0	11 mm
K- 07 40 29 32	G 1/8	8 mm	26,5	13 mm
K- 07 40 29 27	G 1/4	4 mm	21,0	9.0 mm
K- 07 40 29 28	G 1/4	6 mm	24,0	11 mm
K- 07 40 29 29	G 1/4	8 mm	25,0	13 mm
K- 07 40 29 26	G 1/4	10 mm	29,5	16 mm
K- 07 40 29 35	G 3/8	8 mm	25,0	13 mm
K- 07 40 29 33	G 3/8	10 mm	29,5	16 mm
K- 07 40 29 34	G 3/8	12 mm	31,0	18 mm
K- 07 40 29 24	G 1/2	10 mm	30,0	16 mm
K- 07 40 29 25	G 1/2	12 mm	31,0	18 mm