

K-XVM ZYL 2

Male connectors, parallel male thread

HANSA FLEX

Özellikler

maks. işletme basıncı	18 bar
kullanılabilir hortumlar	PA, PE, PU
Malzeme	Nikel kaplı pirinç

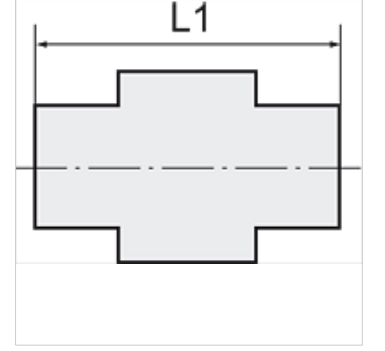
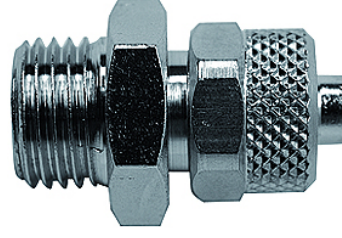

Açıklama

Diğer bilgiler, istek üzerinedir.

Ürün

Tanım	Mil	Hortum için	L1 (mm)	SW
K- 07 40 33 54	M 5	5 mm / 3 mm	21,0	8 mm
K- 07 40 33 55	M 5	6 mm / 4 mm	21,0	8 mm
K- 07 40 33 60	G 1/8	5 mm / 3 mm	23,0	14 mm
K- 07 40 33 61	G 1/8	6 mm / 4 mm	25,5	13 mm
K- 07 40 33 62	G 1/8	8 mm / 6 mm	25,5	14 mm
K- 07 40 33 59	G 1/8	10 mm / 8 mm	27,5	14 mm
K- 07 40 33 57	G 1/4	6 mm / 4 mm	28,0	16 mm
K- 07 40 33 58	G 1/4	8 mm / 6 mm	28,0	16 mm
K- 07 40 33 56	G 1/4	10 mm / 8 mm	29,5	16 mm
K- 07 40 33 65	G 3/8	6 mm / 4 mm	29,0	19 mm
K- 07 40 33 66	G 3/8	8 mm / 6 mm	29,0	19 mm
K- 07 40 33 63	G 3/8	10 mm / 8 mm	30,5	19 mm
K- 07 40 33 64	G 3/8	12 mm / 10 mm	32,0	19 mm