

# K-VHR IS BUND ES

Hexagon socket screw plugs with collar

**HANSA FLEX**

## Özellikler

|                 |                        |
|-----------------|------------------------|
| Çalışma basıncı | Max. 20 bar            |
| Model           | Blok Tapa              |
| Malzeme         | Paslanmaz çelik 1.4571 |

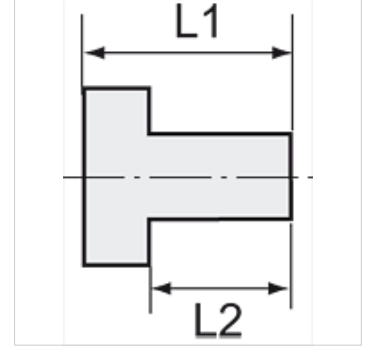
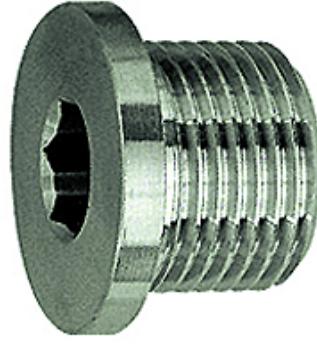

## Açıklama

The dimensions of the standard screw fittings may change slightly during the life of the catalogue as a result of optimisation processes. Diğer bilgiler, istek üzerinedir.

## Ek bilgiler

Further types and dimensions on request.

## Ürün

| Tanım          | Mil   | L1<br>(mm) | L2<br>(mm) | SW    |
|----------------|-------|------------|------------|-------|
| K- 07 40 39 65 | G 1/8 | 11,0       | 8,0        | 5 mm  |
| K- 07 40 39 66 | G 1/4 | 13,0       | 10,0       | 6 mm  |
| K- 07 40 39 67 | G 3/8 | 15,0       | 12,0       | 8 mm  |
| K- 07 40 39 68 | G 1/2 | 18,0       | 14,0       | 10 mm |
| K- 07 40 45 22 | G 3/4 | 20,0       | 16,0       | 12 mm |
| K- 07 40 45 25 | G 1   | 21,0       | 16,0       | 17 mm |