

K-SCHLAUCHHALTER ALU

Hose holders, aluminium unpainted

HANSA FLEX

Özellikler

Malzeme Aluminium, unpainted

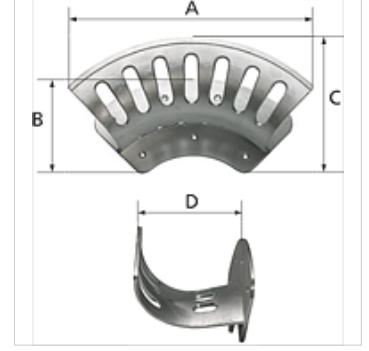
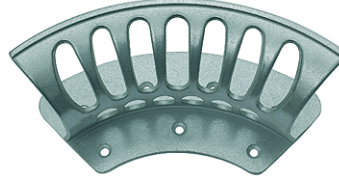

Açıklama

In combination with the rounded holder design, the fact that a small hose holder can be placed inside a large one, or a medium hose holder inside a maxi one, creates extra storage capacity without any increase in the space required.

Açıklama

Easy mounting on the wall with variable hole pattern (7 drilled holes). Suitable for holding hoses, cables or ropes. Unpainted. Countersunk holes guarantee a smooth surface in the mounting area.

Ürün

Tanım	Boyut	A (mm)	B (mm)	C (mm)	TR (mm)	maks. hortum alma miktarı
K- 07 10 09 88	Small	189,0	86,0	82,0	70,0	For DN 6, 35-40 m
K- 07 10 09 89	Medium	254,0	113,0	108,0	106,0	For DN 9, 45-50 m
K- 07 10 09 90	Large	350,0	151,0	145,0	136,0	For DN 13, 45-50 m
K- 07 10 09 91	Maxi	389,0	170,0	160,0	188,0	For DN 26, 35-40 m