

# K-SCHOTT-STECKVERB VA

Female bulkhead connectors

**HANSA FLEX**

## Özellikler

Atar çalışma basıncı	Max. 10 bar
Basınç	Max. 15 bar (depending on pipe quality)
uygun boru malzemesi	PVDF, PTFE, stainless steel, PA, PU
Standart	G thread acc. to DIN EN ISO 228-1
Ortam sıcaklığı	-20 °C to max. +150 °C (depending on pipe quality and diameter)
Malzeme	Paslanmaz çelik 1.4404
Yalıtım malzemesi	FKM

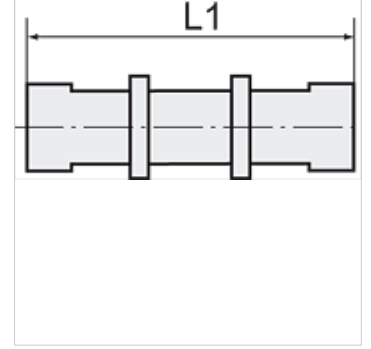
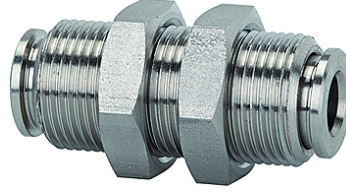

## Açıklama

Diğer bilgiler, istek üzerinedir.

## Açıklama

For use with aggressive media and in areas with corrosive outside influences, in the food processing industry and in hygienic and sanitary applications.

## Ürün

Tanım	Mil	Hortumun dış çapı için	L1 (mm)	SW
K- 07 40 24 30	M 12 x 1.0	4 mm	28,0	15 mm
K- 07 40 24 31	M 14 x 1.0	6 mm	34,4	17 mm
K- 07 40 24 32	M 16 x 1.0	8 mm	34,5	19 mm
K- 07 40 24 33	M 18 x 1.0	10 mm	38,6	21 mm
K- 07 40 24 34	M 20 x 1.0	12 mm	40,8	24 mm