

K-STECKVERSCHR ABSP AGR OR

Straight stop valves, parallel male thread with O-ring

HANSA FLEX

Özellikler

| | |
|--------------------------|--|
| Çalışma basıncı | Max. 10 bar, vacuum |
| Kullanım Alanı | Air, vacuum |
| Tavsiye edilen hortumlar | PU or PA (nylon) |
| Akışkanlar | Basıncılı hava |
| Standart | G thread acc. to DIN EN ISO 228-1, with O-Ring |
| Sıcaklık sahası | 0 °C to +60 °C |
| Conta yüzeyi | O-ring (NBR) |
| Malzeme | Plastic, Nickel plated brass |
| Bastırma halkası | Plastic |

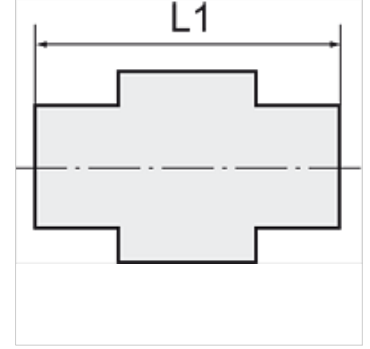
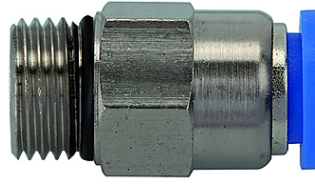

Açıklama

Diğer bilgiler, istek üzerinedir.

Açıklama

The air supply is completely shut off as soon as the hose is disconnected from the union.
The flow rate is only guaranteed if the hose is securely inserted.

Ürün

| Tanım | Mil | Hortumun dış çapı için | L1 (mm) | SW |
|----------------|-------|------------------------|------------|-------|
| K- 07 40 08 18 | G 1/8 | 4 mm | 27,5 | 14 mm |
| K- 07 40 08 19 | G 1/8 | 6 mm | 27,0 | 14 mm |
| K- 07 40 08 20 | G 1/8 | 8 mm | 29,0 | 14 mm |
| K- 07 40 08 16 | G 1/4 | 6 mm | 27,0 | 17 mm |
| K- 07 40 08 17 | G 1/4 | 8 mm | 29,0 | 17 mm |
| K- 07 40 08 15 | G 1/4 | 10 mm | 37,0 | 17 mm |
| K- 07 40 08 23 | G 3/8 | 8 mm | 29,0 | 20 mm |
| K- 07 40 08 21 | G 3/8 | 10 mm | 37,0 | 20 mm |
| K- 07 40 08 22 | G 3/8 | 12 mm | 38,0 | 21 mm |
| K- 07 40 08 13 | G 1/2 | 10 mm | 37,0 | 24 mm |
| K- 07 40 08 14 | G 1/2 | 12 mm | 38,0 | 24 mm |