

# K-MV G (NC) D 230 V, 50 HZ H 1

Normally closed, (NC), directly operated, 230 V, 50 Hz, for high pressures

**HANSA FLEX**

## Özellikler

<b>Elektrik bağlantısı</b>	device socket type A in acc. with ISO 4400 for all valves with threads G 3/8 & G 1/2, except valves type 3 & 4. Device socket
<b>Dişli açıklaması</b>	G thread acc. DIN EN ISO 228-1
<b>Akışkan sıcaklığı</b>	max. 80 °C when using water or oils; max. 90 °C when using with air
<b>Koruma sınıfı</b>	IP 65
<b>maks. işletme basıncı</b>	30 bar
<b>Yalıtım malzemesi</b>	FPM
<b>Mahfaza, valf yuvası</b>	Stainless steel 1.4301
<b>İç parçalar</b>	Stainless steel

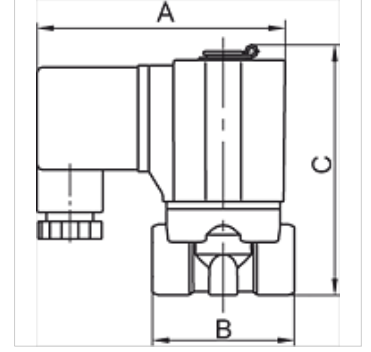
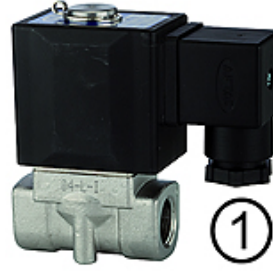

## Açıklama

Diğer bilgiler, istek üzerinedir.

## Açıklama

Standard series in two different versions: Directly operated, Pilot-operated

## Ürün

Tanım	Mil	NW	A (mm)	B (mm)	C (mm)	Form
K- 07 30 01 16	G 1/8	1,5	70,0	40,0	70,7	1
K- 07 30 01 17	G 1/4	1,5	70,0	40,0	70,7	1
K- 07 30 01 18	G 3/8	3,0	85,0	52,0	87,0	1
K- 07 30 01 19	G 1/2	3,0	85,0	52,0	87,0	1