

K-SV POM

Bulkhead connectors

HANSA FLEX

Özellikler

Çalışma basıncı	0 - 16 bar (4 - 8 mm); 0 - 10 bar (10 - 28 mm)
İşletim ısısı	-20 °C to +70 °C in air; +1 °C to +70 °C in water
Malzeme	Acetalpolymerisat (POM)
Yalıtım malzemesi	NBR

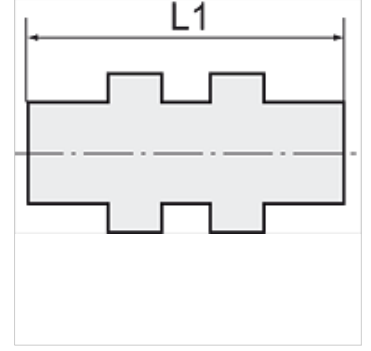
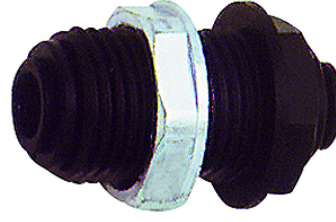

Açıklama

Diğer bilgiler, istek üzerinedir.

Açıklama

Lightweight, push-in fittings distinguished by high strength, toughness, resistance to abrasion and impact resistance - ideal for a wide range of applications. Plastic and metal tubes are connected together quickly and easily. Suitable for compressed air or liquids, with good resistance to a large number of chemicals.

Ürün

Tanım	Mil	Hortumun dış çapı için	L1 (mm)	SW
K- 07 40 28 77	G 3/8	6 mm	36,5	19 mm
K- 07 40 28 76	G 1/2	8 mm	42,0	22 mm