

K-MV G (NC) D 24 V DC H

Normally closed, (NC), directly operated, 24 V DC, for high pressures

HANSA FLEX

Özellikler

Elektrik bağlantısı	device socket type A in acc. with ISO 4400 for all valves with threads G 3/8 & G 1/2, except valves type 3 & 4. Device socket
Dişli açıklaması	G thread acc. DIN EN ISO 228-1
Akışkan sıcaklığı	max. 80 °C when using water or oils; max. 90 °C when using with air
Koruma sınıfı	IP 65
maks. işletme basıncı	30 bar
Yalıtım malzemesi	FPM
Mahfaza, valf yuvası	Stainless steel 1.4301
İç parçalar	Stainless steel

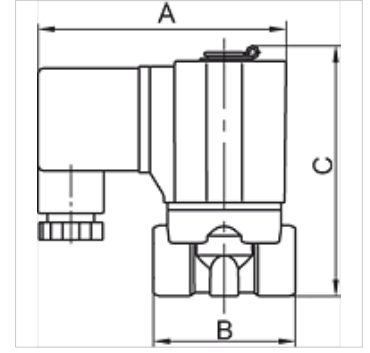
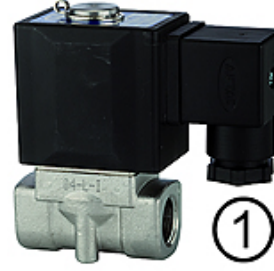

Açıklama

Diğer bilgiler, istek üzerinedir.

Açıklama

Standard series in two different versions: Directly operated, Pilot-operated

Ürün

Tanım	Mil	NW	A (mm)	B (mm)	C (mm)	Form
K- 07 30 01 24	G 1/8	1,5	70,0	40,0	70,7	1
K- 07 30 01 25	G 1/4	1,5	70,0	40,0	70,7	1
K- 07 30 01 26	G 3/8	3,0	85,0	52,0	87,0	1
K- 07 30 01 27	G 1/2	3,0	85,0	52,0	87,0	1