

K-TUE IG ES

Female hose fittings with female thread stainless steel

HANSA FLEX

Özellikler

Çalışma basıncı	Max. 20 bar
Malzeme	Paslanmaz çelik 1.4571

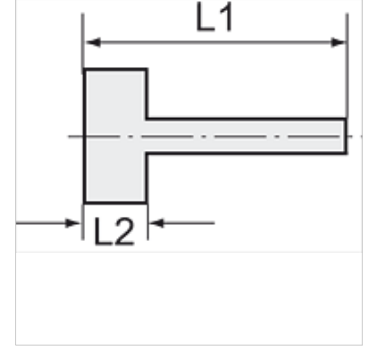
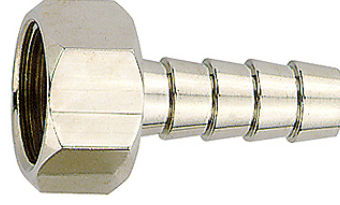

Açıklama

The dimensions of the standard screw fittings may change slightly during the life of the catalogue as a result of optimisation processes. Diğer bilgiler, istek üzerinedir.

Ek bilgiler

Further types and dimensions on request.

Ürün

Tanım	Mil	Hortum için	L1 (mm)	L2 (mm)	SW
K- 07 40 13 30	G 1/8	LW 6 mm	35,0	10,0	12 mm
K- 07 40 13 31	G 1/8	LW 8 mm	35,0	10,0	12 mm
K- 07 40 13 32	G 1/4	LW 6 mm	36,0	11,0	17 mm
K- 07 40 13 33	G 1/4	LW 8 mm	36,0	11,0	17 mm
K- 07 40 13 34	G 1/4	LW 10 mm	36,0	11,0	17 mm
K- 07 40 13 35	G 1/4	LW 13 mm	40,5	11,0	17 mm
K- 07 40 13 36	G 3/8	LW 6 mm	36,0	11,0	19 mm
K- 07 40 13 37	G 3/8	LW 8 mm	36,0	11,0	19 mm
K- 07 40 13 38	G 3/8	LW 10 mm	36,0	11,0	19 mm
K- 07 40 13 39	G 3/8	LW 13 mm	40,5	11,0	19 mm
K- 07 40 13 40	G 1/2	LW 6 mm	39,0	14,5	24 mm
K- 07 40 13 41	G 1/2	LW 8 mm	39,0	14,5	24 mm
K- 07 40 13 42	G 1/2	LW 10 mm	39,0	14,5	24 mm
K- 07 40 13 43	G 1/2	LW 13 mm	44,0	14,5	24 mm