

K-MV O (NO) D 24 V DC STA VA

Normally open, (NO), directly operated, 24 V DC, standard type VA

HANSA FLEX

Özellikler

Elektrik bağlantısı	device socket type A in acc. with ISO 4400 for all valves with threads G 3/8 & G 1/2, except valves type 3 & 4. Device socket
Dişli açıklaması	G thread acc. DIN EN ISO 228-1
Akışkan sıcaklığı	max. 80 °C when using water or oils; max. 90 °C when using with air
Koruma sınıfı	IP 65
maks. işletme basıncı	7 bar
Yalıtım malzemesi	FPM
Mahfaza, valf yuvası	Stainless steel 1.4301
İç parçalar	Stainless steel

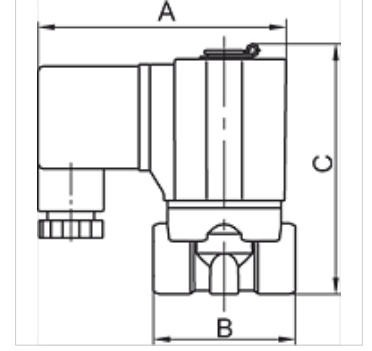

Açıklama

Diğer bilgiler, istek üzerinedir.

Açıklama

Standard series in two different versions: Directly operated, Pilot-operated

Ürün

Tanım	Mil	NW	A (mm)	B (mm)	C (mm)	Form
K- 07 30 01 42	G 1/8	3,0	70,0	40,0	76,0	2
K- 07 30 01 43	G 1/4	3,0	70,0	40,0	76,0	2
K- 07 30 01 44	G 3/8	5,0	85,0	52,0	92,0	2
K- 07 30 01 45	G 1/2	5,0	85,0	52,0	92,0	2