

# G HN VA

## 连接接套

### 属性

接口 1	NPT外螺纹
密封形式 1	螺纹密封式
接口 2	NPT外螺纹
密封形式 2	螺纹密封
结构类型	接头管套
结构形式	直道
原料	不锈钢

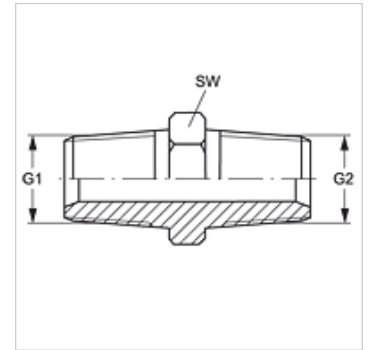

### 货品

名称	G1	G2	SW (mm)
G HN 02 VA	1/8" -27 NPT	1/8" -27 NPT	12
G 04 HN 02 VA	1/4" -18 NPT	1/8" -27 NPT	16
G HN 04 VA	1/4" -18 NPT	1/4" -18 NPT	14
G 06 HN 02 VA	3/8" -18 NPT	1/8" -27 NPT	19
G 06 HN 04 VA	3/8" -18 NPT	1/4" -18 NPT	19
G HN 06 VA	3/8" -18 NPT	3/8" -18 NPT	19
G 08 HN 04 VA	1/2" -14 NPT	1/4" -18 NPT	22
G 08 HN 06 VA	1/2" -14 NPT	3/8" -18 NPT	22
G HN 08 VA	1/2" -14 NPT	1/2" -14 NPT	22
G 12 HN 08 VA	3/4" -14 NPT	1/2" -14 NPT	29
G HN 12 VA	3/4" -14 NPT	3/4" -14 NPT	27
G 16 HN 08 VA	1" -11.5 NPT	1/2" -14 NPT	35
G 16 HN 12 VA	1" -11.5 NPT	3/4" -14 NPT	36
G HN 16 VA	1" -11.5 NPT	1" -11.5 NPT	36
G HN 20 VA	1.1/4" -11.5 NPT	1.1/4" -11.5 NPT	46
G HN 24 VA	1.1/2" -11.5 NPT	1.1/2" -11.5 NPT	50
G HN 32 VA	2" -11.5 NPT	2" -11.5 NPT	65

SW = 对应边宽度

### 产品变体

G HN 连接接套, 钢