

K-VAKUUMSCHALTER

Vacuum switch

HANSA FLEX

属性

测量介质接口	G 1/8 male and M 5 female
输出信号	Analogue: 1 to 5 V
电接口	Male connector M8, four pin
滞后	Adjustable: 3 to 25% of set value
适用介质	Non-aggressive gases. dry, oil-free air
开关功能	PNP
开关性能	125 mA
电流消耗	30 mA
温度范围	0 - 50 °C
壳体	Polycarbonate

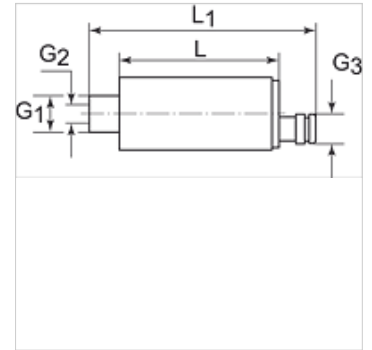

提示

其它数据应客户要求提供。

描述

Universal electronic vacuum switch for safety monitoring, optimisation of cycle times and regulation circuits. Its small size and low weight permit installation directly on the suction pad.
Switching point and hysteresis adjustable with a screw. Integrated LED for indication of the switching state.

货品

名称	外侧 G1	内侧 G2	外侧 G3	L (mm)	L1 (mm)	测量范围	电压
K- 07 45 01 58	G 1/8	M 5	M 8 x 1	44,0	62,0	-1 bis 0 bar	10.8 - 30 V DC