

K-NADELVENTILE VA

Needle valves

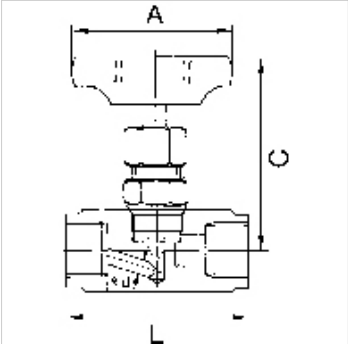

| | |
|------|--|
| 属性 | |
| 工作压力 | max. 400 bar (at 20 °C); max. 250 bar (at G 1 - 20 °C) |
| 工作温度 | -20 °C to +120 °C |
| 密封材料 | PTFE |
| 壳体 | Stainless steel 1.4571 |
| 手轮 | Plastic |
| 原料 | sealing: PTFE |



提示
G thread acc. to DIN EN ISO 228-1, with ISO flange plate (acc. to ISO 5211)
其它数据应客户要求提供。

订购指南
For use on devices that have to be vented whenever they are turned off, either because of safety regulations or for technical reasons. The pneumatic devices are disconnected from the system and simultaneously vented each time they are shut off.

附加信息
Port sizes G 1 1/4, G 1 1/2 and G 2 available on request

| 货品 | | | | | |
|----------------|----|-------|-----------|-----------|-----------|
| 名称 | DN | 螺纹 | A (mm) | C (mm) | L (mm) |
| K- 07 30 24 03 | 4 | G 1/8 | 50,0 | 74,0 | 50,0 |
| K- 07 30 24 04 | 5 | G 1/4 | 50,0 | 73,0 | 50,0 |
| K- 07 30 24 05 | 6 | G 3/8 | 50,0 | 72,0 | 55,0 |
| K- 07 30 24 06 | 8 | G 1/2 | 63,0 | 83,0 | 60,0 |
| K- 07 30 24 07 | 10 | G 3/4 | 63,0 | 100,0 | 75,0 |
| K- 07 30 24 08 | 12 | G 1 | 80,0 | 110,0 | 100,0 |