

K-ABBLV 2

Blow-off safety valves G 1/4

HANSA FLEX

属性

| | |
|------|--------------|
| 工作压力 | 0.5 - 60 bar |
| 工作温度 | max. 180 °C |
| 密封 | FKM |
| 壳体 | Brass |

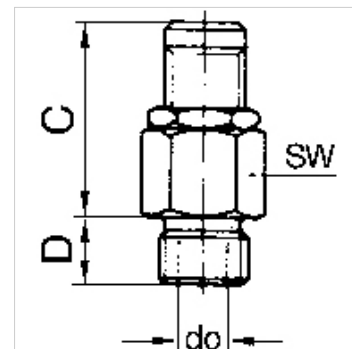

提示

G thread acc. to DIN EN ISO 228-1, with ISO flange plate (acc. to ISO 5211)
其它数据应客户要求提供。

描述

Manual adjustment of the blow-off pressure (lock nut).

订购指南

For use on devices that have to be vented whenever they are turned off, either because of safety regulations or for technical reasons. The pneumatic devices are disconnected from the system and simultaneously vented each time they are shut off.

附加信息

These blow-off valves can also be supplied with a fixed setting and a TÜV type test number. Please ask for an offer.

货品

| 名称 | 螺纹 | 起动压力 | 排气性能 | C (mm) | D (mm) | do (mm) | SW (mm) |
|----------------|-------|-----------------|---------------|-----------|-----------|------------|------------|
| K- 07 30 29 18 | G 1/4 | 0.5 - 1.0 bar | to 50 l/min | 27,0 | 7,0 | 3,0 | 16 |
| K- 07 30 21 95 | G 1/4 | 1.0 - 4.0 bar | to 200 l/min | 27,0 | 7,0 | 3,0 | 16 |
| K- 07 30 21 96 | G 1/4 | 3.0 - 7.0 bar | to 350 l/min | 27,0 | 7,0 | 3,0 | 16 |
| K- 07 30 21 97 | G 1/4 | 6.0 - 12.0 bar | to 650 l/min | 27,0 | 7,0 | 3,0 | 16 |
| K- 07 30 21 98 | G 1/4 | 10.0 - 18.0 bar | to 870 l/min | 27,0 | 7,0 | 3,0 | 16 |
| K- 07 30 21 99 | G 1/4 | 16.0 - 32.0 bar | to 1600 l/min | 27,0 | 7,0 | 3,0 | 16 |
| K- 07 30 22 00 | G 1/4 | 30.0 - 60.0 bar | to 3000 l/min | 27,0 | 7,0 | 3,0 | 16 |