

K-W90 STUECK AG IG 2 2

Elbows, male-female

HANSA FLEX

属性

工作压力	60 bar
工作温度	Max. 150 °C
内螺纹	Parallel to DIN EN ISO 228-1
原料	Brass with a bare metal surface
外螺纹	conical acc. DIN 2999

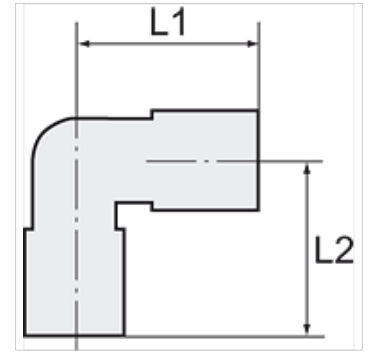
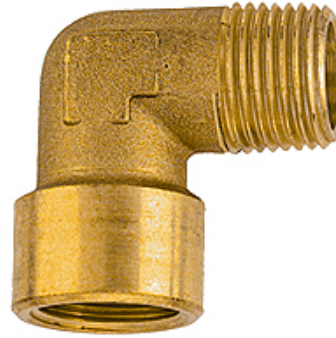

提示

其它数据应客户要求提供。

货品

名称	螺纹	L1 (mm)	L2 (mm)	SW
K- 07 40 11 32	G/R 1/8	18,5	21,0	10 mm
K- 07 40 11 33	G/R 1/4	23,5	25,5	13 mm
K- 07 40 11 34	G/R 3/8	26,0	28,0	17 mm
K- 07 40 11 35	G/R 1/2	31,0	33,5	21 mm
K- 07 40 11 36	G/R 3/4	33,0	36,5	25 mm
K- 07 40 11 37	G/R 1	39,0	45,0	30 mm